



Tryten Nova Motion/Tall/Connect-O Assembly Instructions

For further instructions please visit **[Tryten.com/instructions](https://tryten.com/instructions)**.

For additional questions or technical support contact us at
[Tryten.com/contact](https://tryten.com/contact) or 1-800-860-4455.

Assembly Instructions	Page
Receiving the Shipping Box	4
Assembling Pole to Base	5
Power Box and Cabling Installation	6
Removing Channel Strips	7
Extension Pole installation	7
Device Height Adjustment	8
Work Surface Installation	9-11
Keyboard Tray Installation	12
Supply Caddy and Transducer Holder Installation	13
Supply Caddy Lockable Lid	14-15
Nova Connect and Tall Vesa Bracket and Monitor Installation	16-17
Nova Connect and Tall Camera Bracket Installation	18-19
Logitech Bracket and Camera Installation	20-21
POLY P15/X30 Mount Installation	22
HD Hinge Installation and Adjustment	23
Yeti-200 Battery Bracket Installation	24
Poly SY20 Speaker installation	25
Speaker Bracket and Speaker Installation	26-27
Handle Installation	27
Intel NUC Bracket and Unit Installation	28

NOVA HARDWARE PACK

- Label Hardware Kit Nova (1)
- Hex L-Key - 3/16" size (1)
- Torx Security L-Key - T25 (1)
- Hex L-Key - 5/32" size (1)
- Keys Set Tablet Cart Nova (1)
- Screw 10-24 x 3/4" Security Torx, Button head, SS (1)
- Screw 1/4-20 by 1" Socket Head, Zinc (4)
- Belleville (dome) Washer 1/4" 18-8 SS (4)

ADDITIONAL TOOLS NEEDED FOR INSTALLATION

- Scissors for cutting channel cover to length

ASSEMBLY INSTRUCTIONS

Note: Shipping box pictures show Nova Tall Cart for assembly reference. Configurations may vary, but the installation process will be similar.

INSTALLATION OF ACCESSORIES TO THE CARTS

Note: When installing accessories, the Z or T-Nut has to be loose and aligned vertically (up/down) when inserted into the extrusion channel. Once adjusted at the desired height, tighten the screw until it is fully locked to the extrusion. Always verify that the nut is aligned horizontally (left/right) when fully tightened.



1. RECEIVING THE SHIPPING BOX

- Base.



- Extract the Hardware Pack.



- Remove Pole Assembly from packaging.



2. ASSEMBLING THE POLE TO BASE

- Assemble the Pole to the base with the four (4) screws and dome washers using the 3/16" Hex L-Key from the Hardware Pack.

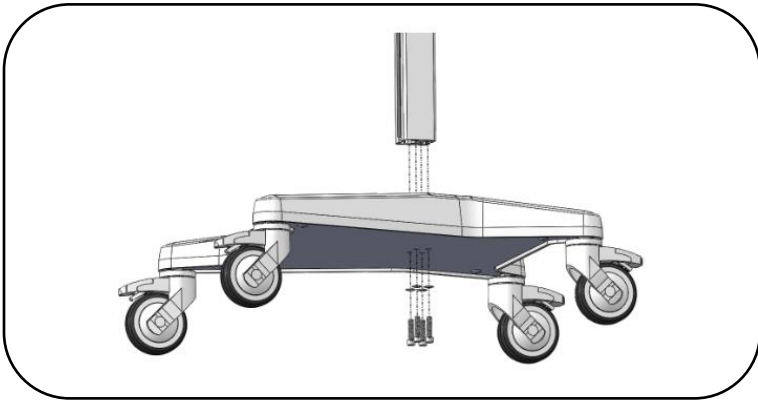
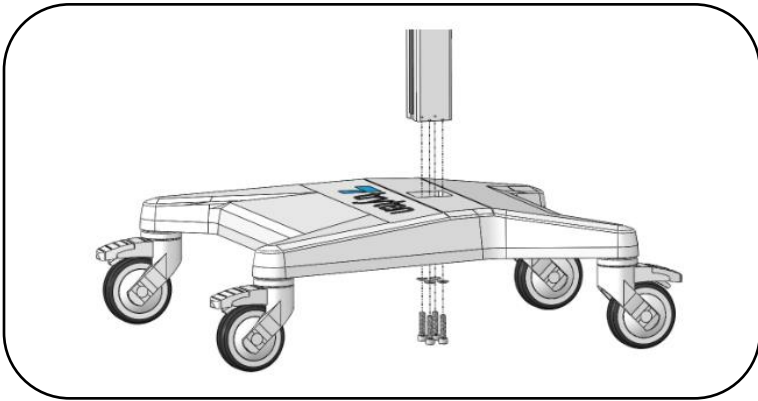

3. POWER BOX AND CABLING INSTALLATION

- Install Utility box by loosening Z-Nuts, insert Z-Nuts into extrusion channel, slide box up or down to desired height and tighten screws.
- Open box by using Torx Security L-Key, loosen two (2) screws from the back of the Power Box until cover swings open.
- Install 9' Green Dot Hospital Grade Power Extension Cable as shown (see middle image).
- Install tablet's power cable through hole and up the channel as shown.
- Close door back in place and re-install the screws from back.

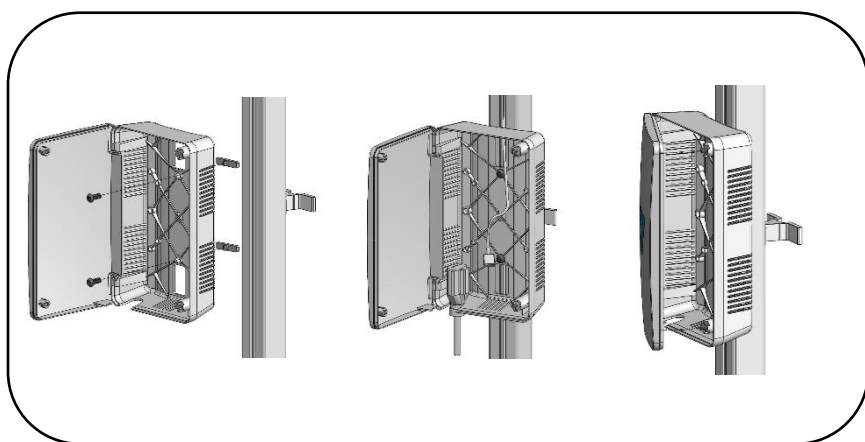

STORING THE POWER CORD

When the cart is not in use, or devices are not being charged, the extension cord should be wrapped and stored on the unit. Wrap the cable firmly around the upper handle and lower cord wraps located on the back of the unit pole.

4. REMOVING THE CHANNEL STRIPS

- Insert one (1) of the smaller Allen L-Keys behind the top of the channel cover to pull out of the pole. Reinstall covers

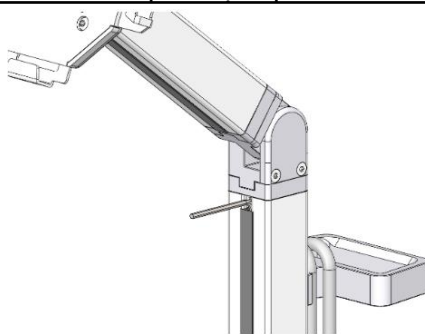

Note: Channel Cover Strips will need to be adjusted if accessories are installed.

5. EXTENSION POLE INSTALLATION

- On the Nova Connect, shown below left, assemble the extension pole to the offset adapter with the two (2) screws (1") using the 3/16" Allen L-Key.
- On the Nova Tall, shown below right, assemble with one (1) screw using Torx Security L-Key provided in hardware pack.

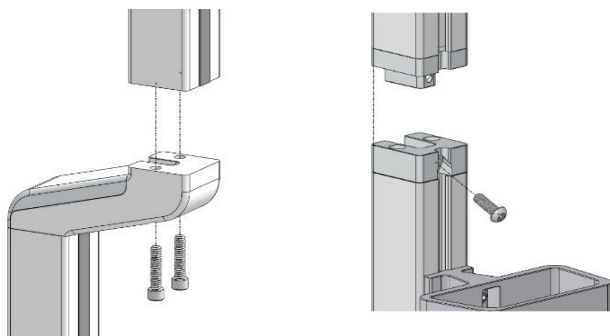

6. DEVICE HEIGHT ADJUSTMENT

- In order to adjust the height of the surface or keyboard tray, the handle may need to rotate to add more turns. The handle is spring loaded so it can be rotated to a different position to tighten the assembly. With assembly loose, move assembly to desired height. Tighten the handle and lock the device in place by turning the handle clockwise. If the handle cannot turn anymore and the assembly is not yet tight, pull the handle out (image 1), rotate counterclockwise and release handle back in place (image 3) to tighten the assembly. Repeat process until device is fully tightened.
- Work Surface adjustment

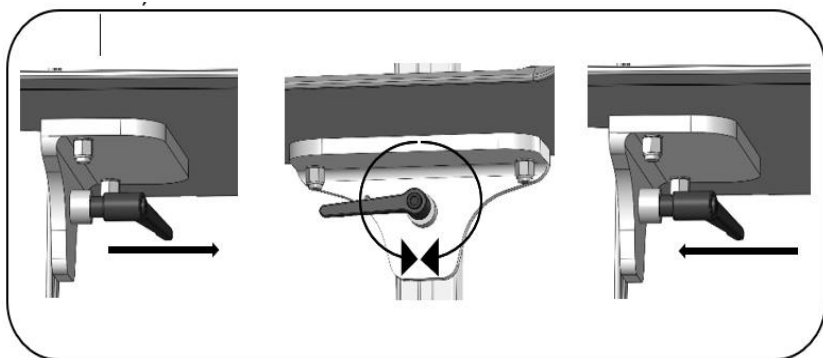
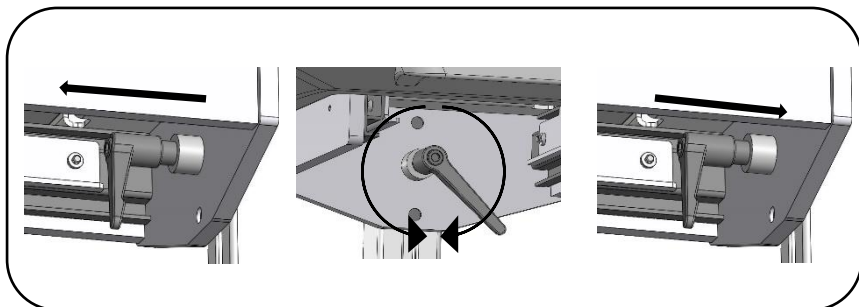

7. NOVA TALL WORK SURFACE INSTALLATION

- Remove channel cover strip (ref. point 4).
- Remove articulating arm or tall pole with one (1) screw using Torx Security L-Key provided in hardware pack.
- Remove extrusion adapter by removing two (2) 1/4" screws with 3/16" Hex L-Key provided.

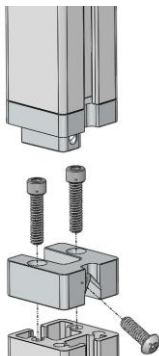

- Slide Work Surface down from top and secure at desired height (ref. point 6).
- Reinstall Extrusion Adapter and Tall Pole.

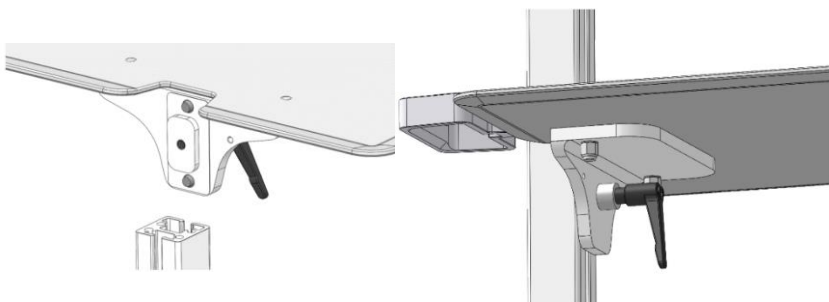

8. NOVA MOTION – WORK SURFACE INSTALLATION

- Remove channel cover strip (ref. point 4).
- Remove Pole Cap with rear screw using Torx Security L-Key.
- Remove Extrusion Adapter with two (2) screws from top using 3/16" Hex L-Key.
- Slide Work Surface down from top and secure at desired height (ref. point 6).

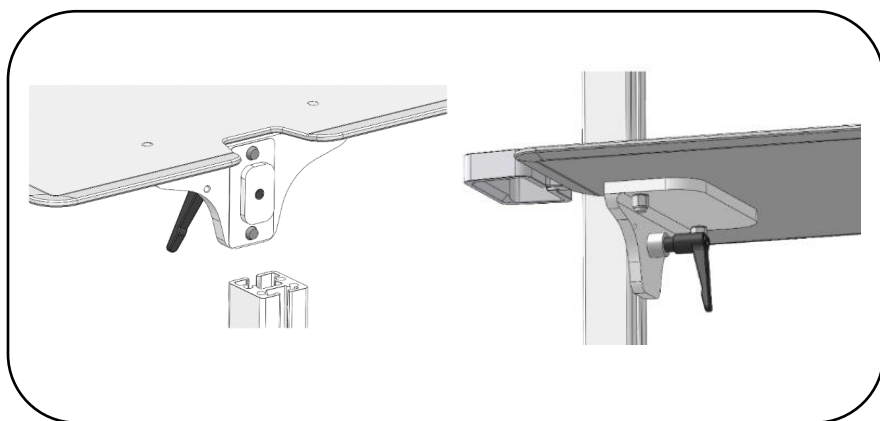
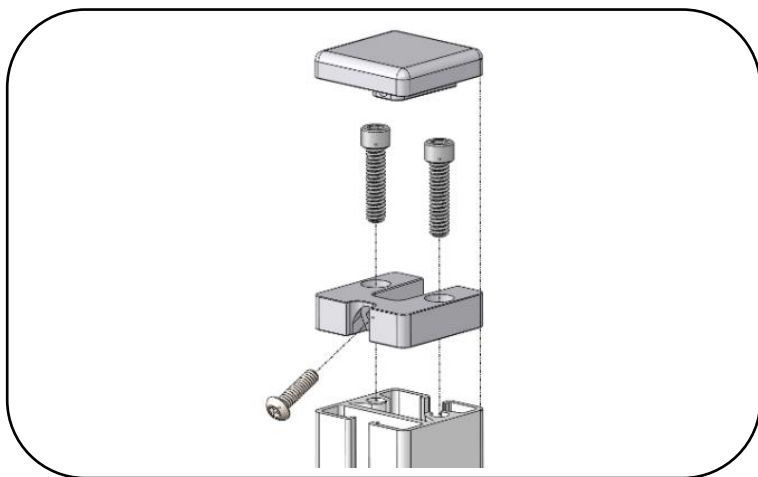

9. NOVA CONNECT – WORK SURFACE INSTALLATION

- Remove channel cover strip (ref. point 4).
- Remove two (2) screws from underneath to remove offset adapter cap using Torx Security L-Key provided.

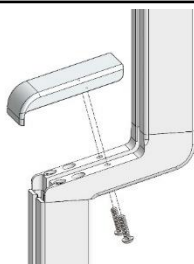

- Slide Work Surface down channel from top, set and lock with handle at desired height (ref. point 6).
- Re-install offset adapter cap.

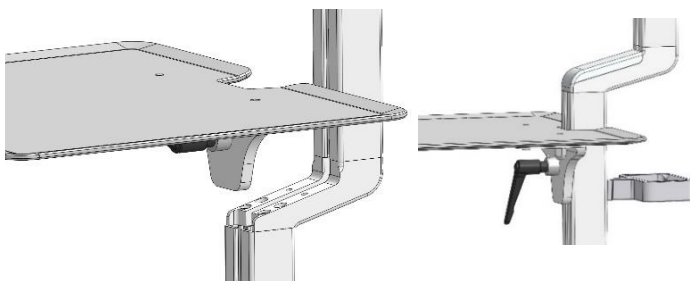

- To move handle to a more desirable location; pull handle out, rotate CW or CCW and release handle (ref. point 6).

10. NOVA CONNECT - KEYBOARD TRAY INSTALLATION

- Remove channel cover strip (ref. point 4).
- Remove two (2) screws from underneath to remove offset adapter cap using Torx Security L-Key provided.

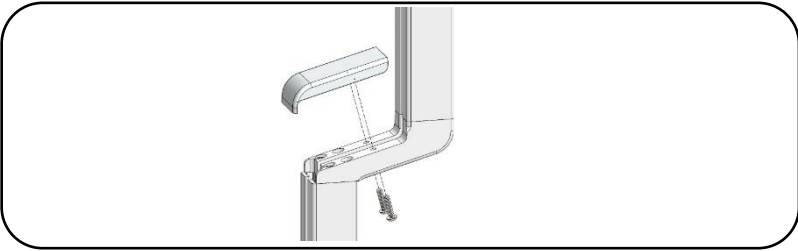

- Slide Keyboard Tray down channel from top, set and lock with handle at desired height (ref. point 7).
- Re-install offset adapter cap to pole.

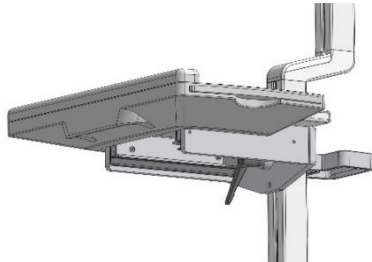
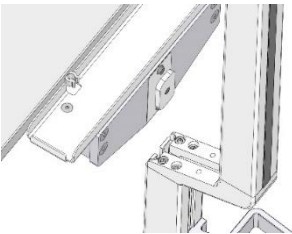

To move handle to a more desirable location; pull handle out, rotate CW or CCW and release handle (ref. point 6).

11. SUPPLY CADDY & TRANSDUCER HOLDER INSTALLATION

The Supply Caddy and Transducer Holder each come in two (2) parts – the Caddy/Holder and the Mounting Bracket and Hardware to attach to the pole.

- Remove channel cover strip (ref. point 4).
- Install Caddy/Holder bracket with two (2) 1/4" Screws and two (2) Z-Nuts as shown below with 5/32" L-Key provided in hardware pack.
- Adjust bracket to desired height and tighten screws.
- Slide the Supply Caddy or Transducer Holder onto the Mounting Bracket from above until it snaps in place.

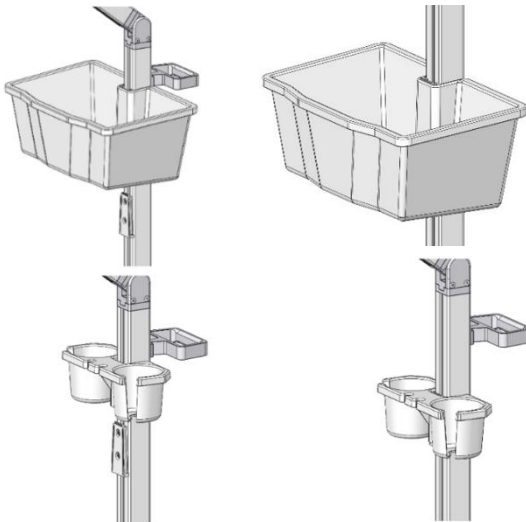
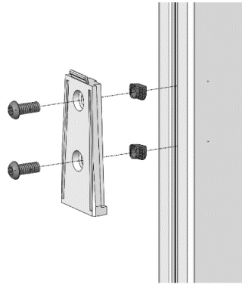

12.1 SUPPLY CADDY LOCKABLE LID

- Loosen Z-Nut from screw but do not remove.
- Rotate Z-Nut so it slides into the channel.
- Lower entire lid until it rests on the Caddy.
- Fasten lid to pole by using Torx Security L-Key (provided) and turn screw until tight.

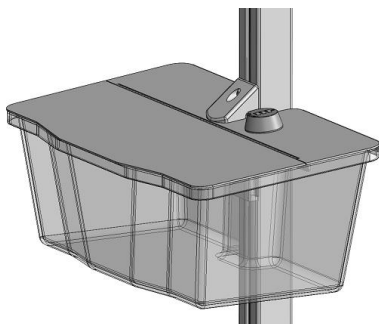
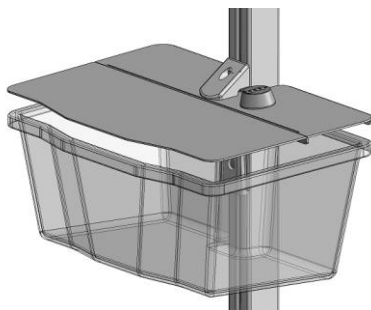

12.2 SETTING PERSONAL COMBINATION NUMBERS

- Factory combination is set at 0-0-0
- Combination must be on opening numbers prior to resetting.
- You will find a hole on the outer ring for code reset, see picture.
- Rotate lock until reset button comes into view.
- Push pin with paper clip or small pin and keep it pushed in.
- Set numbers to desired combination.
- Release button and your new combination is set.

To lock, rotate to 'locked' position, rotate one or more dials.

To unlock, rotate dials to personal combination and 'unlock'.

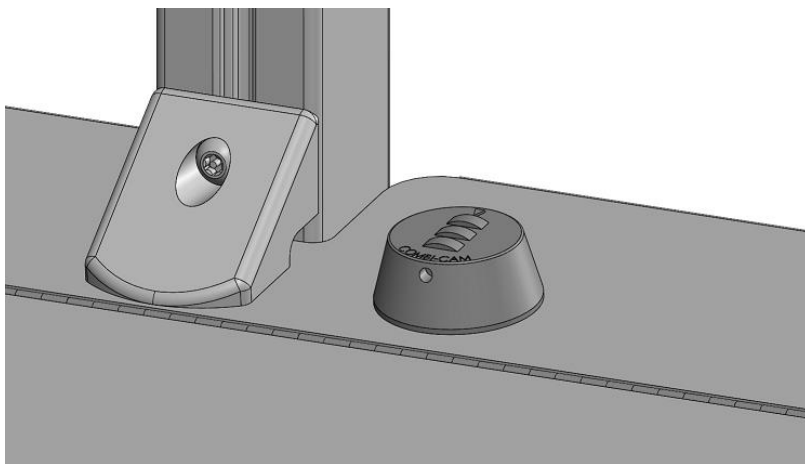

13. NOVA CONNECT & TALL – FIXED VESA BRACKET & MONITOR INSTALLATION

- Remove channel cover strip (ref. point 4).
- Install bracket to extrusion with two (2) screws and two (2) Z-Nuts.

Note: Ensure the thicker section of the bracket is mounted at the top.

- Install VESA plate to bracket with four (4) button head screws.
- Install Monitor to VESA plate with four (4) mounting screws (not included).

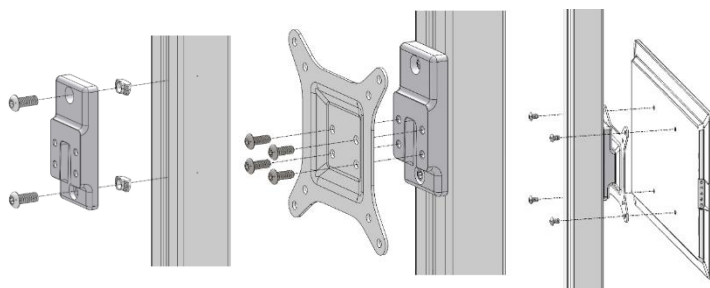

14. NOVA CONNECT & TALL – TILTING VESA BRACKET & MONITOR INSTALLATION

- Remove channel cover strip (ref. point 4).
- Install bracket to extrusion with two (2) screws and two (2) Z-Nuts.

Note: Ensure the thicker section of the bracket is mounted at the top FOR ALL VESA BRACKETS.

- Install VESA plate to bracket with four (4) button head screws.
- Install Monitor to VESA plate with four (4) mounting screws (not included).

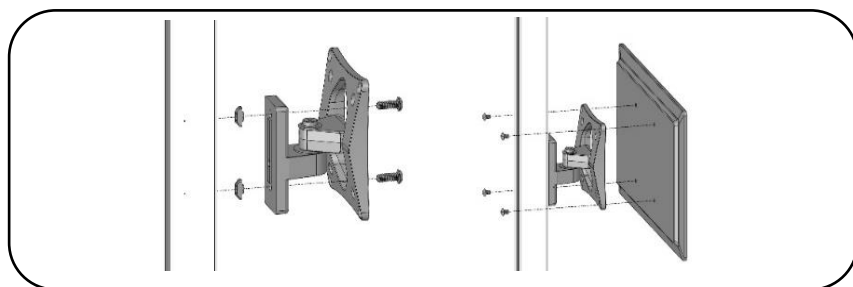

15. NOVA CONNECT & TALL – ARTICULATING VESA BRACKET & MONITOR INSTALLATION

- Remove channel cover strip (ref. point 4).
- Install bracket to extrusion with two (2) screws and two (2) Z-Nuts.
- Remove two (2) cover screws using Torx Security L-Key.
- Rotate plastic cover to install Monitor to VESA plate with four (4) mounting screws (not included).
- Re-install two (2) cover screws.

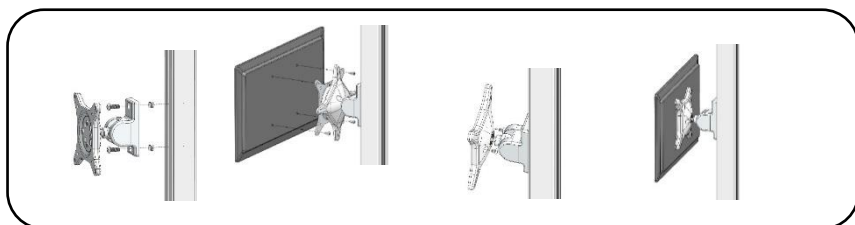

16. NOVA CONNECT & TALL – UNIVERSAL ANGLE BRACKET & CAMERA INSTALLATION

- Remove channel cover strip (ref. point 4).
- Install camera bracket to extrusion with two (2) screws and two (2) Z-Nuts.
- Align the alignment hole on camera with protruding alignment screw on bracket.
- Use screw and Allen L-Key provided to install camera on bracket.
- Remove alignment screw and install from opposite side to mount camera opposite way.

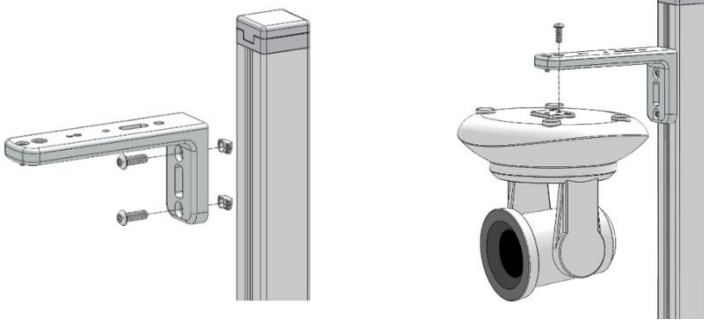

17. NOVA CONNECT & TALL – FIXED CAMERA BRACKET & CAMERA INSTALLATION

- Remove channel cover strip (ref. point 4).
- Remove cap and adapter with Allen L-Key provided (if necessary).
- Install fixed camera bracket using two (2) 1/4" cap screws.
- Align the alignment hold on camera with protruding alignment screw on bracket.
- Use screw and Allen L-Key provided to install camera on bracket, remove alignment screw and install from opposite side to mount camera opposite way.

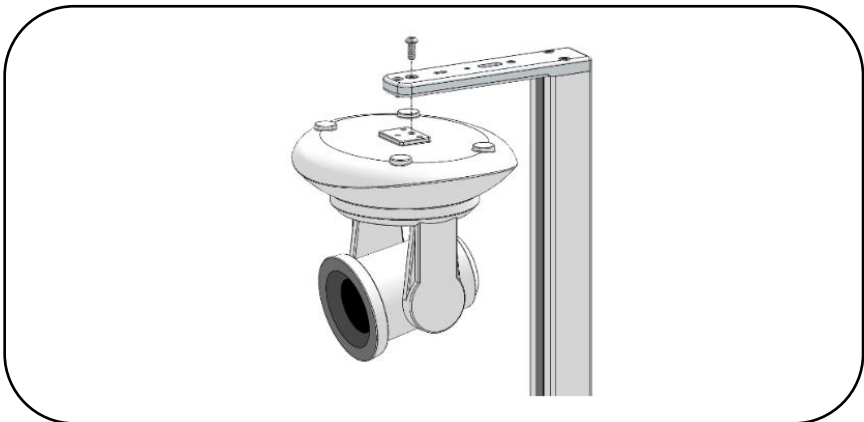
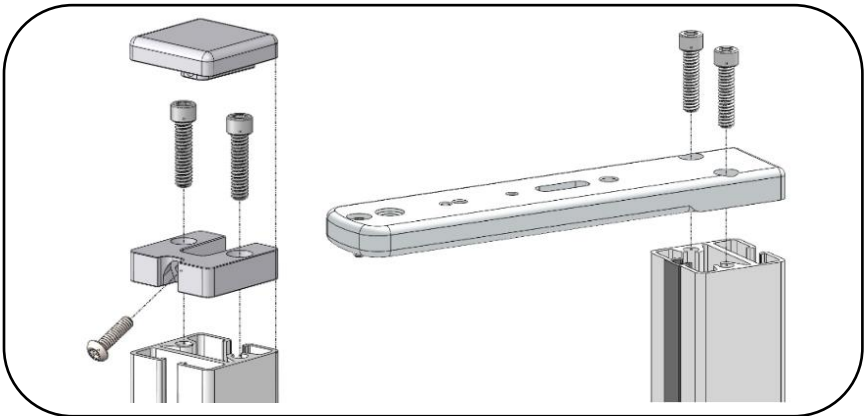

18. LOGITECH MEETUP & RALLY, FIXED BRACKET – BRACKET & CAMERA INSTALLATION

- Remove channel cover strip (ref. point 4).
- Install Logitech bracket to extrusion with one (1) screw and (1) Z-Nut.
- Remove screws and cap with Allen L-Key provided.
- Install camera by placing camera slot over bracket ledge.
- Re-install screws and cap with Allen L-Key provided.

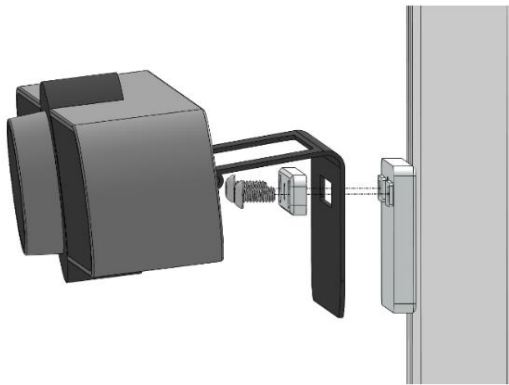
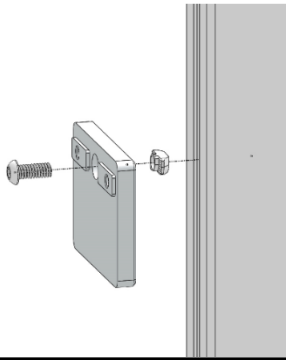

19. LOGITECH MEETUP & RALLY, 180 PAN BRACKET – BRACKET & CAMERA INSTALLATION

- Remove channel cover strip (ref. point 4).
- Install Logitech bracket to extrusion with two (2) screws and two (2) Z-Nuts.
- Remove screws and cap with Allen L-Key provided.
- Install camera by placing camera slot over bracket ledge.
- Re-install screws and cap with Allen L-Key provided.

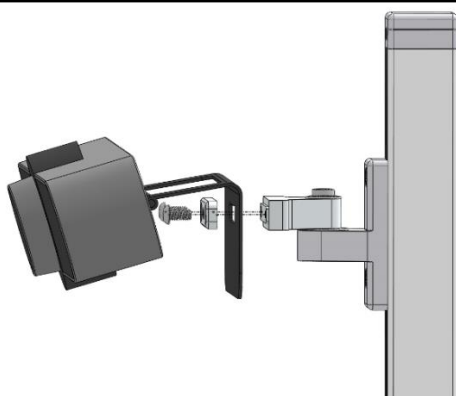
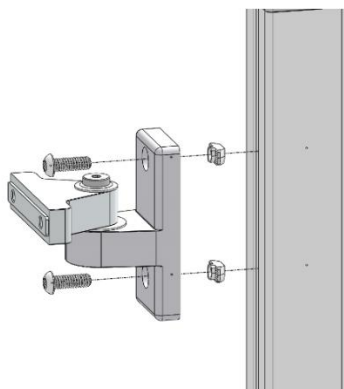

20. POLY P15/X30 MOUNT INSTALLATION

- Remove channel cover strip (ref. point 4).
- Loosen T-Nut but do not remove, place T-Nut into the extrusion channel, move bracket up or down to desired height.
- Tighten bracket to extrusion with screw and T-Nut.
- Install camera/speaker, as per example. (P15 shown)

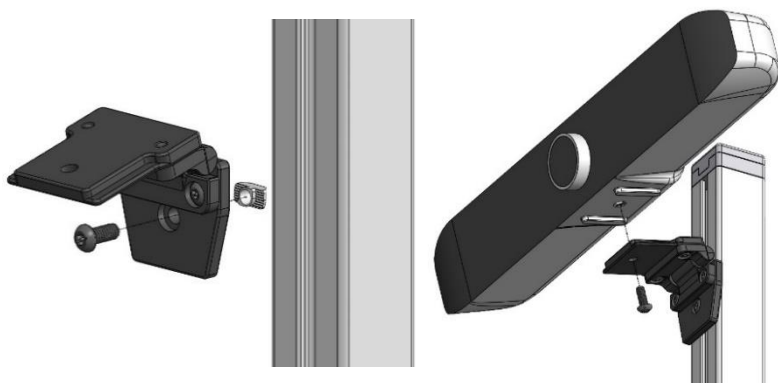

- To adapt the mount from P15 to X30 or reverse, undo two (2) screws from hinge and flip plate over, re-install two (2) screws.

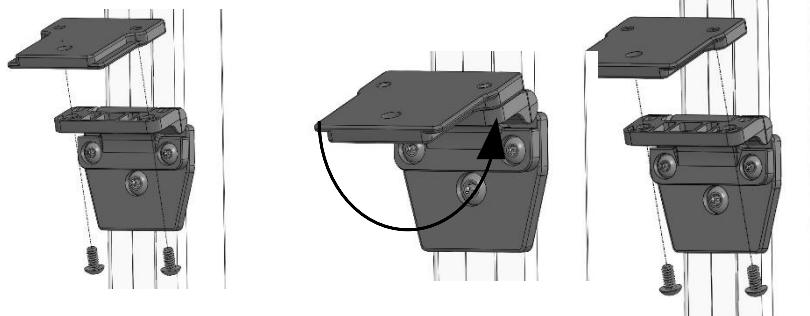

21. HD HINGE INSTALLATION AND ADJUSTMENT

- Remove channel cover strip (ref. point 4).
- Install HD Hinge to extrusion by having two (2) screws and T-Nuts loose, insert in channel, move up or down to desired position and tighten screws.
- To adjust, rotate handle CCW to loosen just enough to rotate hinge up or down to desired position, rotate handle CW to tighten.

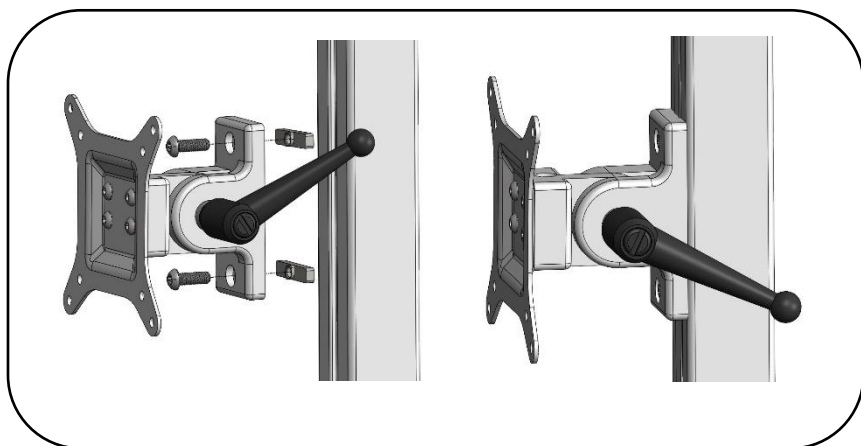

- To move handle to a more desirable location; pull handle out, rotate CW or CCW and release handle. For locking handle operation see point 7.

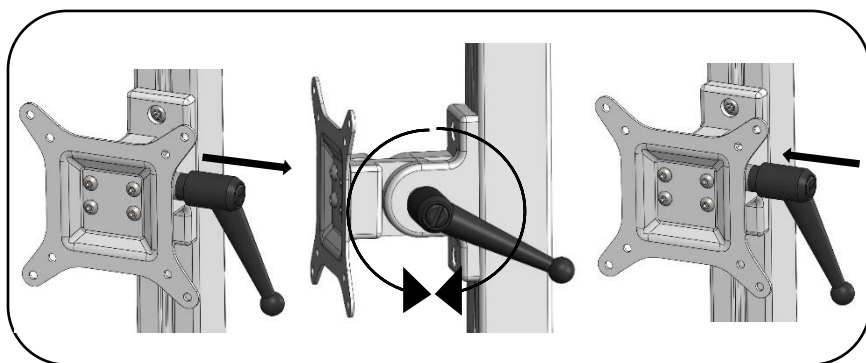

22. YETI 200 BRACKET INSTALLATION

- Remove channel cover strip (ref. point 4).
- Install Yeti 200 platform bracket to extrusion by having two (2) screws and T-Nuts loose, insert into the extrusion channel, move up or down to desired position and tighten screws.
- Place battery on platform.
- Place handle bracket around the green handle as the Z-Nut is inserted into the channel, place bracket on battery and tighten screw.

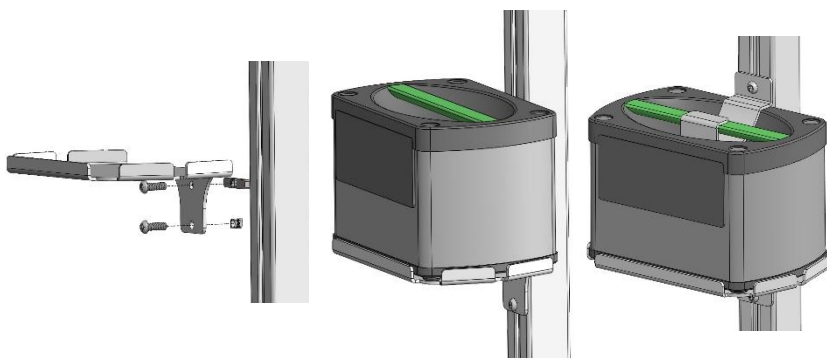

23. POLY SY20 SPEAKER INSTALLATION

- Remove channel cover strip (ref. point 4).
- Loosen T-Nut but do not remove, place T-Nut into the extrusion channel, move bracket up or down to desired height.
- Tighten bracket to extrusion with screw and T-Nut.
- Slide speaker back ridge into the fixed bracket, slide clamp bracket onto speaker and align two (2) screw holes.
- Install and tighten two (2) screws.

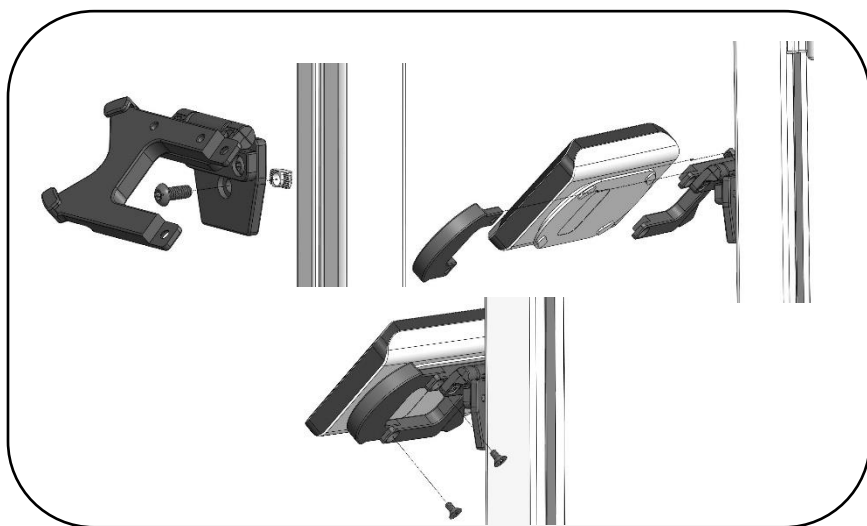

24. JABRA 410/510 – BRACKET & SPEAKER INSTALLATION

- Remove channel cover strip (ref. point 4).
- Remove screw and cap using Torx Security L-Key provided.
- Install Jabra 410 and 510 Bracket to extrusion with screw and Z-Nut.
- Install speaker by sliding speaker ledge into bracket lip with wire either at top or bottom.
- Re-install cap and screw using Torx Security L-Key provided.

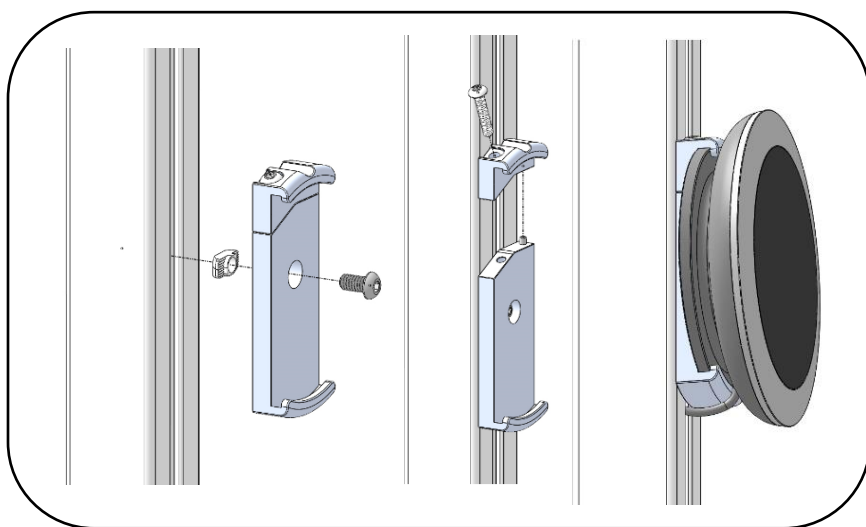

25. JBL CHARGE 4/5 AND FLIP 4/5 – BRACKET & SPEAKER INSTALLATION

- Remove channel cover strip (ref. point 4).
- Install JBL Charge bracket to extrusion with two (2) screws and two (2) Z-nuts.
- Remove screws and cap using Torx Security L-Key provided.
- Install speaker by sliding speaker ledge into bracket lip.
- Re-install cap and screw using Torx Security L-Key provided.

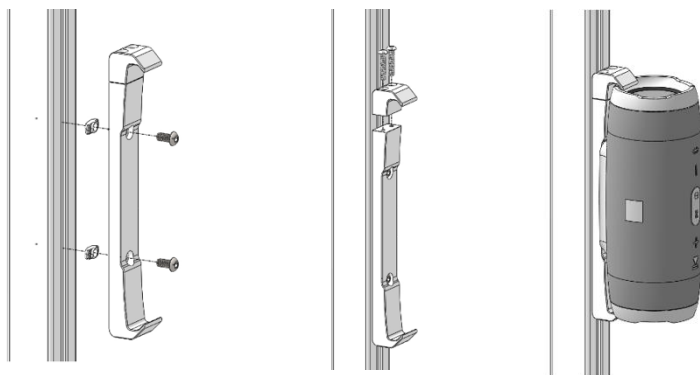

26. HANDLE INSTALLATION (Optional Accessory)

- Install Handle by loosening T-Nut, insert T-Nut into extrusion channel, slide handle up or down to desired height and tighten screw.
- Press protective plastic cap on to end of screw head.

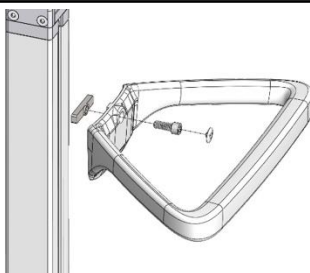

27. INTEL NUC – BRACKET & UNIT INSTALLATION

- Remove channel cover strip (ref. point 4).
- Install Intel NUC bracket to extrusion with screw and Z-Nut.
- Install Intel NUC by lining up holes of bracket and unit.
- Install two (2) screws with Allen L-Key provided.

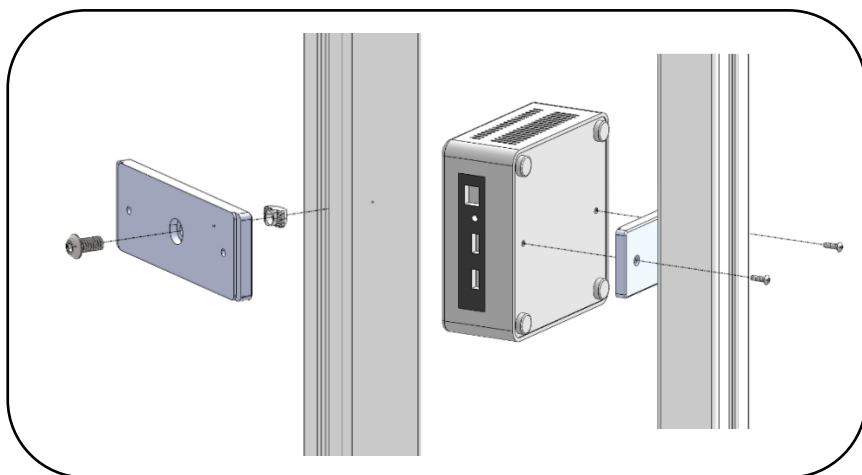

END OF NOVA ASSEMBLY INSTRUCTIONS

For further instructions please visit **[Tryten.com/instructions](https://tryten.com/instructions)**.

For additional questions or technical support contact us at
[Tryten.com/contact](https://tryten.com/contact) or **1-800-860-4455**.

California Proposition 65

This product or its power cord may contain chemicals known to the state of California to cause cancer and birth defects or other reproductive harm. Wash hands after handling.