



Tryten Nova Go/Pro/Neo Line Assembly Instructions

For further instructions please visit **Tryten.com/instructions**.

For additional questions or technical support contact us at
Tryten.com/contact or **1-800-860-4455**.

Assembly Instructions	Page
Receiving the Shipping Box	4
Assembling Pole to Base	5
Universal OmniTab Adjustment	6-8
Removing Channel Strips	9
Nova Go Universal OmniTab Installation	9
Power Box and Cabling Installation	10
Device Height Adjustment	11
Work Surface Installation	12
Supply Caddy and Transducer Holder Installation	13
Supply Caddy Lockable Lid	14-15
Nova Go VESA Bracket and Monitor Installation	16
Nova Neo Vertical Tablet Arm Installation	17
Nova Go and Pro VESA Plate Installation	17
Yeti-200 Battery Bracket Installation	18
Wire Basket Installation	19
Poly SY20 Speaker installation	20
Butterfly Bracket Installation	21
Speaker Bracket and Speaker Installation	22-23

NOVA HARDWARE PACK

- Felt Pads – 3/4" x 1/8" thick (6)
- Label Hardware Kit Nova (1)
- Hex L-Key - 3/16" size (1)
- Torx Security L-Key - T25 (1)
- Hex L-Key - 5/32" size (1)
- Keys Set Tablet Cart Nova (1)
- Screw 10-24 x 3/4" Security Torx, Button head, SS (1)
- Screw 1/4-20 by 1" Socket Head, Zinc (4)
- Belleville (dome) Washer 1/4" 18-8 SS (4)

ADDITIONAL TOOLS NEEDED FOR INSTALLATION

- Scissors for cutting channel cover to length

ASSEMBLY INSTRUCTIONS

Note: Shipping box pictures show Nova Pro Tablet Cart for assembly reference. Configurations may vary, but the installation process will be similar.

INSTALLATION OF ACCESSORIES TO THE CARTS

Note: When installing accessories, the Z or T-Nut has to be loose and aligned vertically (up/down) when inserted into the extrusion channel. Once adjusted at the desired height, tighten the screw until it is fully locked to the extrusion. Always verify that the nut is aligned horizontally (left/right) when fully tightened.



1. RECEIVING THE SHIPPING BOX

- Base.



- Extract the Hardware pack.



- Remove Pole Assembly from packaging.

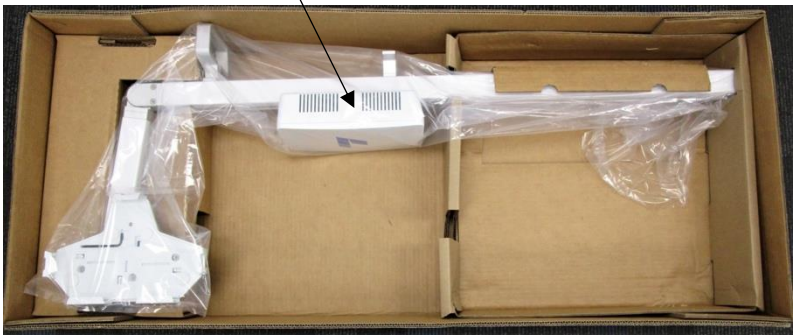

2. ASSEMBLING POLE TO BASE

- Assemble the Pole to the base with the four (4) screws and dome washers using the 3/16" Hex L-Key from the Hardware Pack.

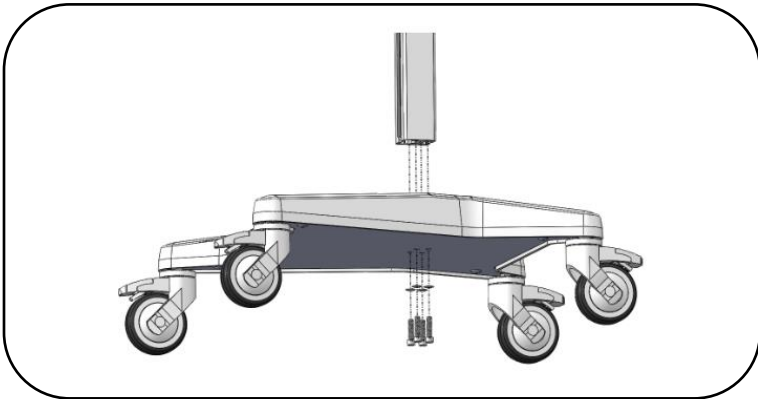
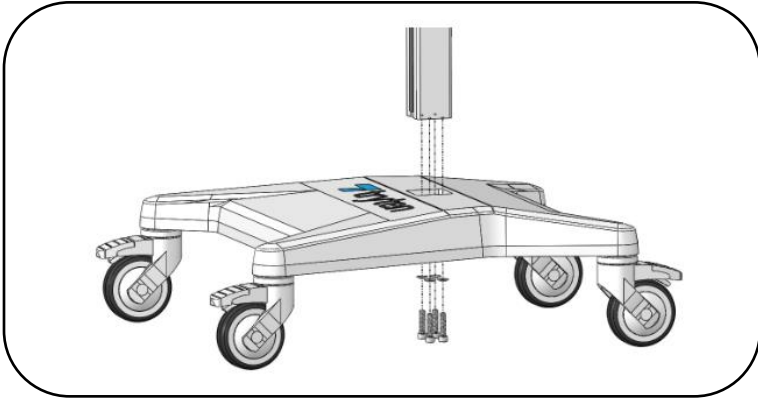

3. (A) UNIVERSAL OMNITAB ADJUSTMENT

The Universal bracket comes adjusted to fit the standard iPad 9.7

- Unlock the Top Slider using the set of keys from the Hardware Pack. Remove the Top Slider from the Universal Bracket.
- Loosen the three (3) screws using the 1/8" Hex L-Key from the front of the cover.

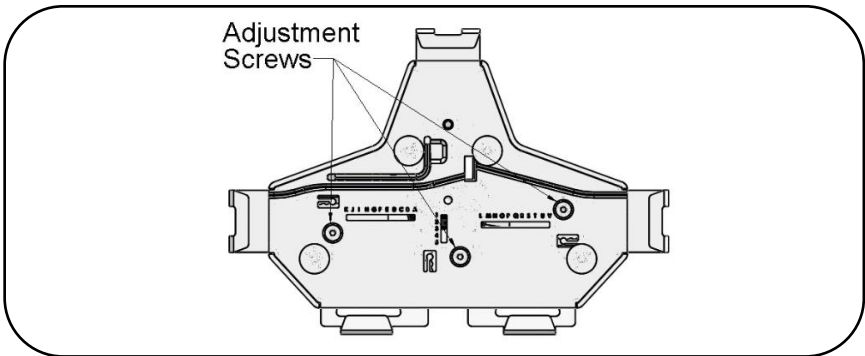

- Pull the sliders to the appropriate size tablet.
- Tighten the three (3) adjustment screws.
- Insert tablet by sliding in from the top.
- Insert the Top Slider until it locks in the tablet and push the locking button.

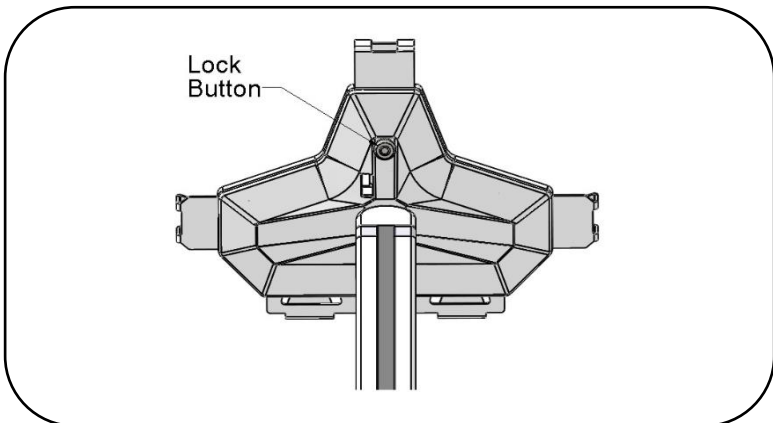

3. (B) INSTALLING 2ND SET OF SLIDERS FOR TABLET WITH CASE

- Remove the four (4) Felt Pads from the Universal Bracket.

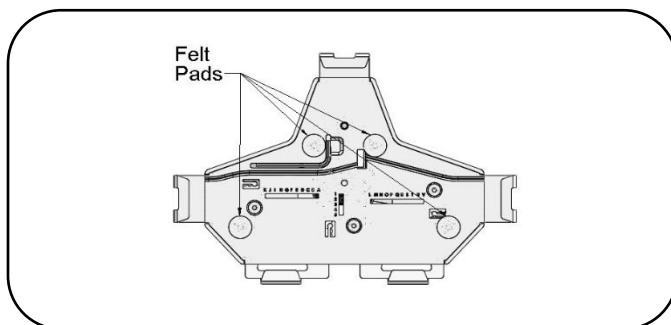

- Remove the four (4) screws holding the cover of the Universal Bracket using the 1/8" Hex L-Key from the front of the cover.

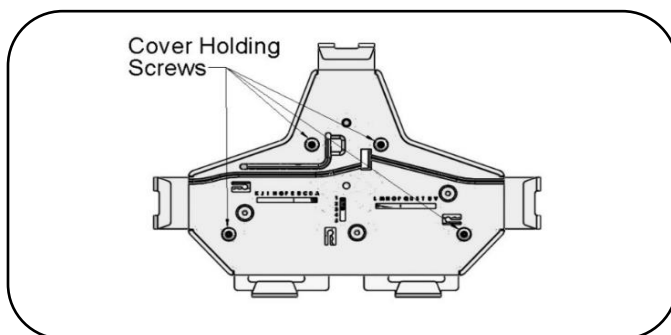

- Remove cover and the three (3) screws holding the sliders using the 1/8" Hex L-Key from the front of the cover.

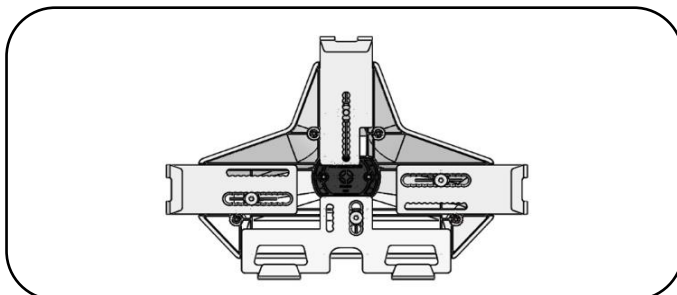

- Remove the four (4) sliders and replace with the set of sliders from Hardware Pack.
- Install the three (3) Screws holding the sliders using the 1/8" Hex L-Key from the front of the cover.

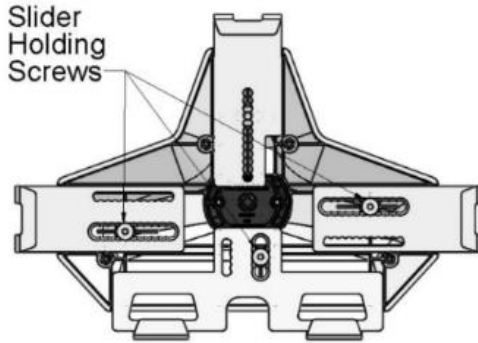

- Put back the cover and install the four (4) screws removed at step b) using the 1/8" Hex L-Key from the front of the cover.
- Apply the set of felt pads supplied in the hardware pack on top of the screws.
- Adjust sliders and install tablet, following the instructions from Step 3A.

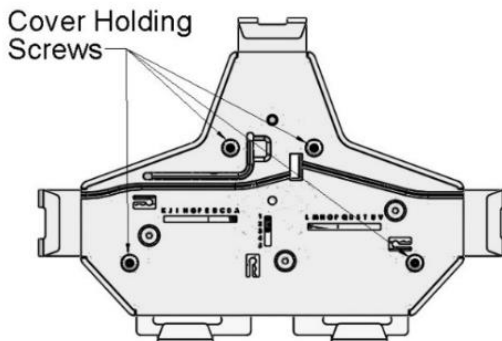

4. REMOVING THE CHANNEL STRIPS

- Insert one (1) of the smaller Allen L-Keys behind the top of the channel cover to pull out of the pole. Reinstall covers after the power cords are in place.

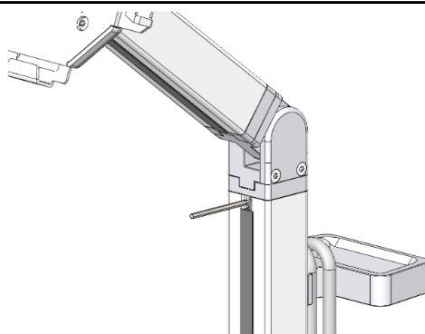

Note: Channel Cover Strips will need to be adjusted if accessories are installed.

5. NOVA GO UNIVERSAL OMNITAB INSTALLATION

- Extract the Nova Go head from packaging box and the Torx Security Button Head Screw from the Hardware Pack.
- Assemble the Nova Go head as shown using the Torx Security L-Key provided in the Hardware Pack.
- Tighten the screw until it is fully engaged.

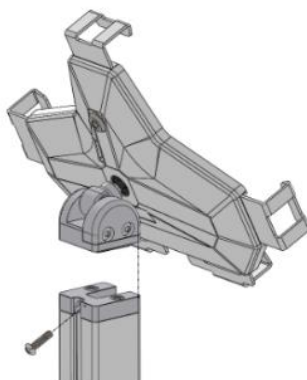

6. POWER BOX AND CABLING INSTALLATION

- Install Utility box by loosening Z-Nuts, insert Z-Nuts into extrusion channel, slide box up or down to desired height and tighten screws.
- Open box by using Torx Security L-Key, loosen two (2) screws from the back of the Power Box until cover swings open.
- Install 9' Green Dot Hospital Grade Power Extension Cable as shown (see middle image).
- Install tablet's power cable through hole and up the channel as shown.
- Close door back in place and re-install the screws from back.

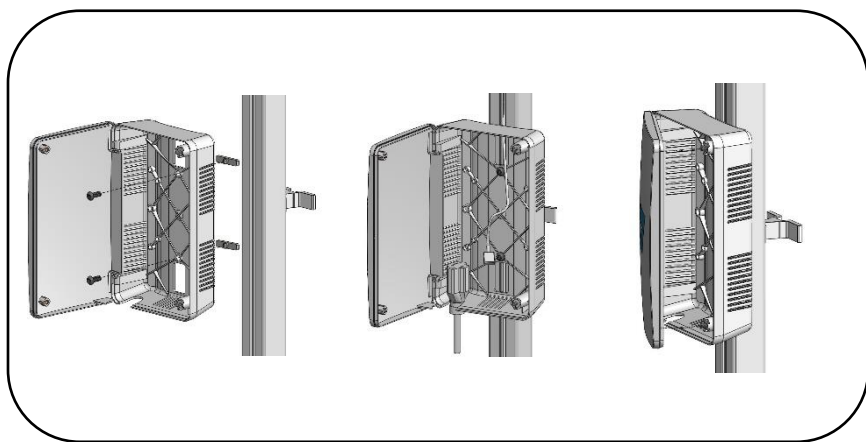

STORING THE POWER CORD

When the cart is not in use, or tablet is not being charged, the extension cord should be wrapped and stored on the unit. Wrap the cable firmly around the upper handle and lower handle Cord Wraps located on the back of the unit pole.

7. DEVICE HEIGHT ADJUSTMENT

- In order to adjust the height of the surface or keyboard tray, the handle may need to rotate to add more turns. The handle is spring loaded so it can be rotated to a different position to tighten the assembly. With assembly loose, move assembly to desired height. Tighten the handle and lock the device in place by turning the handle clockwise. If the handle cannot turn anymore and the assembly is not yet tight, pull the handle out (image 1), rotate counterclockwise and release handle back in place (image 3) to tighten the assembly. Repeat process until device is fully tightened.
- Work Surface adjustment

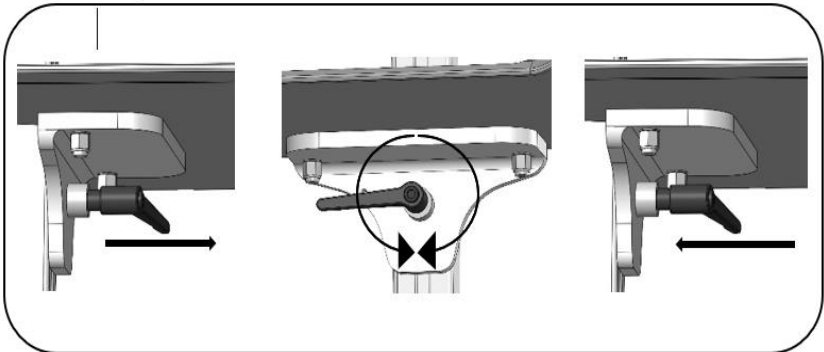

- Keyboard Tray adjustment

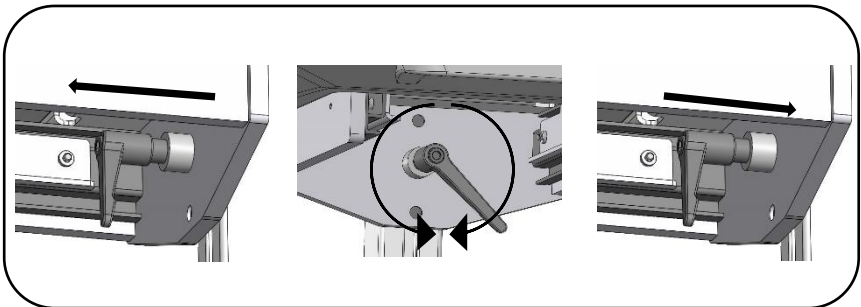

8. NOVA PRO WORK SURFACE INSTALLATION

- Remove channel cover strip (ref. point 4).
- Remove articulating arm or tall pole with one (1) screw using Torx Security L-Key provided in hardware pack.
- Remove extrusion adapter by removing two (2) 1/4" screws with 3/16" Hex L-Key provided.

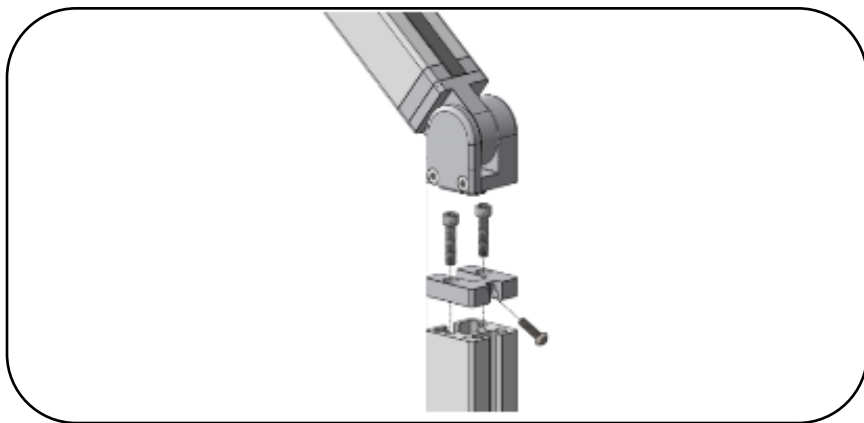

- Slide Work Surface down from top and secure at desired height (ref. point 7).
- Reinstall Extrusion Adapter and Arm.

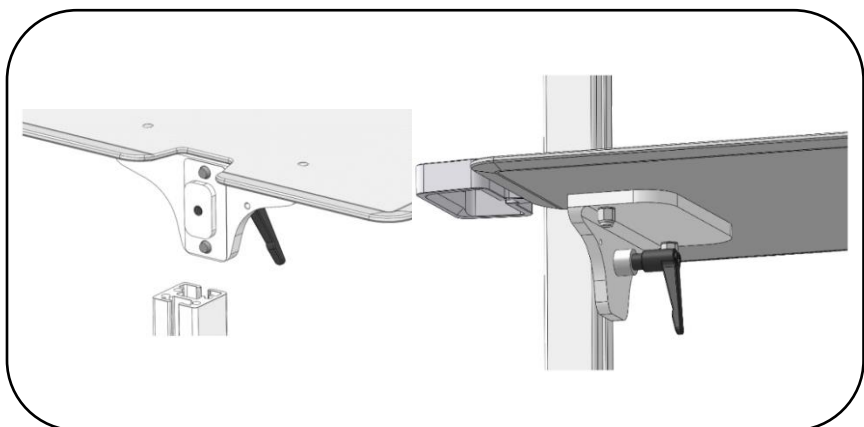

9. SUPPLY CADDY & TRANSDUCER HOLDER INSTALLATION

The Supply Caddy and Transducer Holder each come in two (2) parts – the Caddy/Holder and the Mounting Bracket and Hardware to attach to the pole.

- Remove channel cover strip (ref. point 4).
- Install Caddy/Holder bracket with two (2) 1/4" Screws and two (2) Z-Nuts as shown below with 5/32" L-Key provided in hardware pack.
- Adjust bracket to desired height and tighten screws.
- Slide the Supply Caddy or Transducer Holder onto the Mounting Bracket from above until it snaps in place.

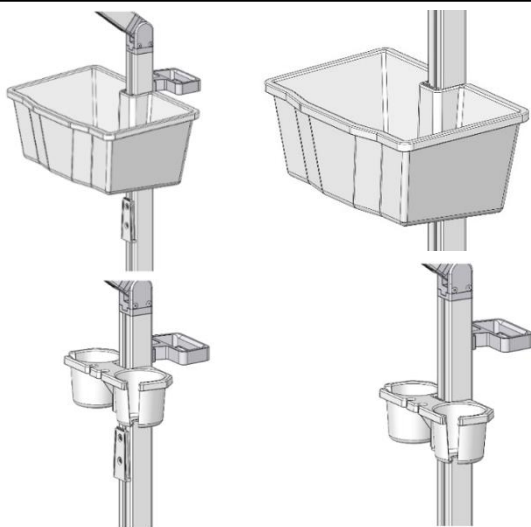
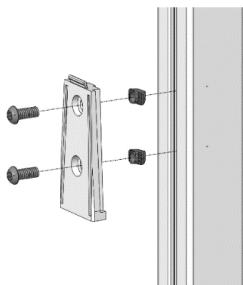

9.1 SUPPLY CADDY LOCKABLE LID

- Loosen Z-Nut from screw but do not remove.
- Rotate Z-Nut so it slides into the channel.
- Lower entire lid until it rests on the Caddy.
- Fasten lid to pole by using Torx Security L-Key (provided) and turn screw until tight.

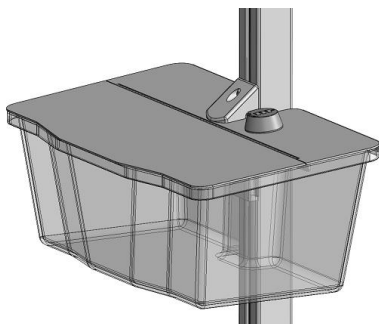
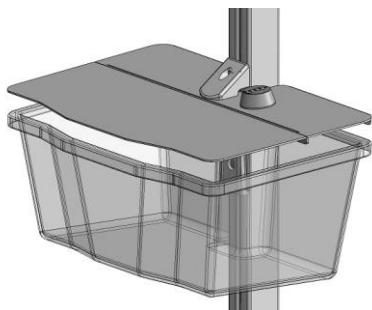

9.2 SETTING PERSONAL COMBINATION NUMBERS

- Factory combination is set at 0-0-0
- Combination must be on opening numbers prior to resetting.
- You will find a hole on the outer ring for code reset, see picture.
- Rotate lock until reset button comes into view.
- Push pin with paper clip or small pin and keep it pushed in.
- Set numbers to desired combination.
- Release button and your new combination is set.

To lock, rotate to 'locked' position, rotate one or more dials.

To unlock, rotate dials to personal combination and 'unlock'.

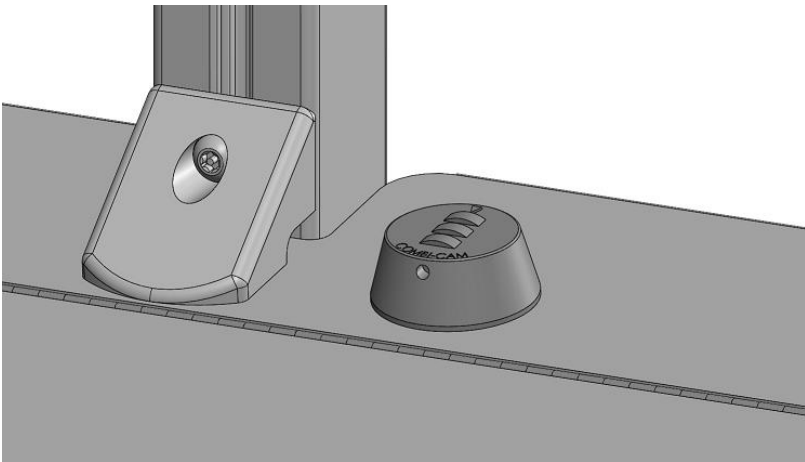

10. NOVA GO VESA – FIXED VESA BRACKET & MONITOR INSTALLATION

- Remove channel cover strip (ref. point 4).
- Install bracket to extrusion with two (2) screws and two (2) Z-Nuts.

Note: Ensure the thicker section of the bracket is mounted at the top.

- Install VESA plate to bracket with four (4) button head screws.
- Install Monitor to VESA plate with four (4) mounting screws (not included).

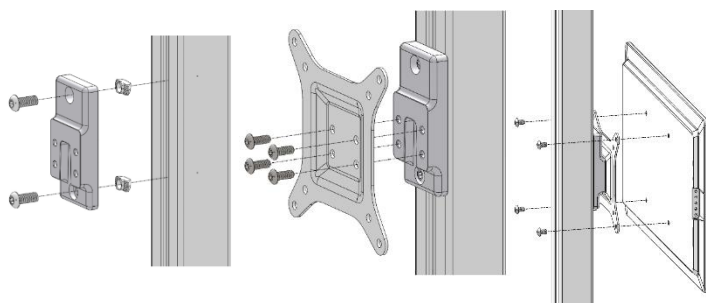

11. NOVA NEO – VERTICAL TABLET ARM INSTALLATION

- Remove channel cover strip (ref. point 4).
- Install Adapter Plate to extrusion with two (2) screws and two (2) Z-Nuts provided.

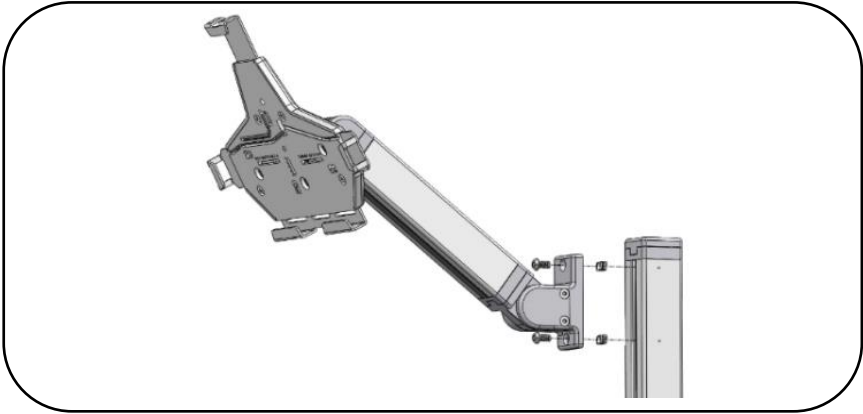

12. NOVA PRO/GO VESA – VESA PLATE INSTALLATION

- Install VESA Mount Plate to adapter with four (4) Button-Head Screws.
- Install monitor or device to VESA Plate with four (4) mounting screws (not included).

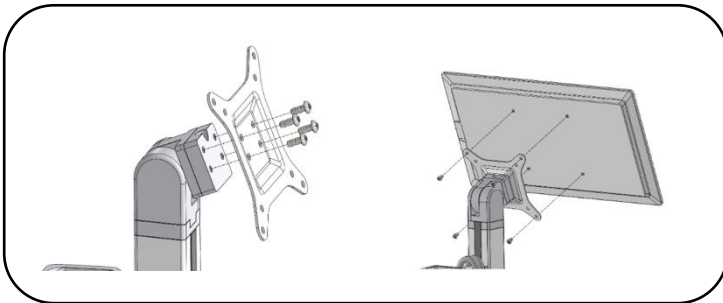

13. YETI 200 BRACKET INSTALLATION

- Remove channel cover strip (ref. point 4).
- Install Yeti 200 platform bracket to extrusion by having two (2) screws and T-Nuts loose, insert into the extrusion channel, move up or down to desired position and tighten screws.
- Place battery on platform.
- Place handle bracket around the green handle as the Z-Nut is inserted into the channel, place bracket on battery and tighten screw.

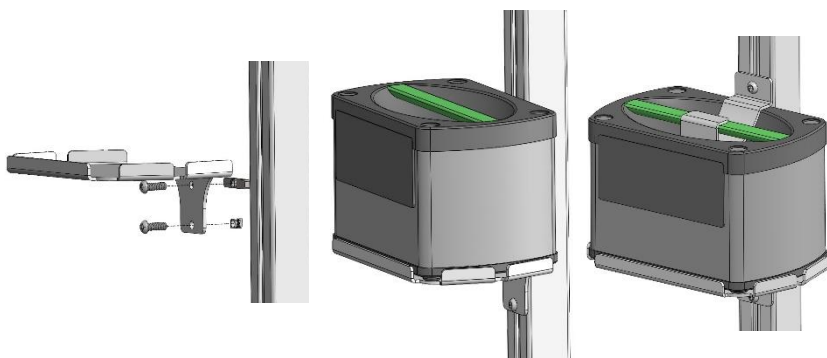

14. WIRE BASKET INSTALLATION

- Remove channel cover strip (ref. point 4).
- Loosen two (2) Z-Nuts but do not remove, place Z-Nuts into the extrusion channel, move basket to desired height.
- Tighten wire basket to extrusion with two (2) screws and two (2) Z-Nuts.

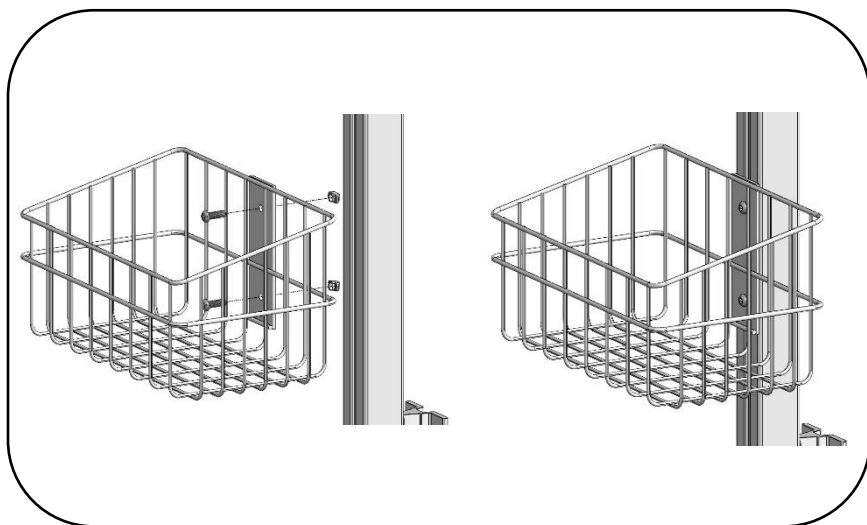

15. POLY SY20 SPEAKER INSTALLATION

- Remove channel cover strip (ref. point 4).
- Loosen T-Nut but do not remove, place T-Nut into the extrusion channel, move bracket up or down to desired height.
- Tighten bracket to extrusion with screw and T-Nut.
- Slide speaker back ridge into the fixed bracket, slide clamp bracket onto speaker and align two (2) screw holes.
- Install and tighten two (2) screws.

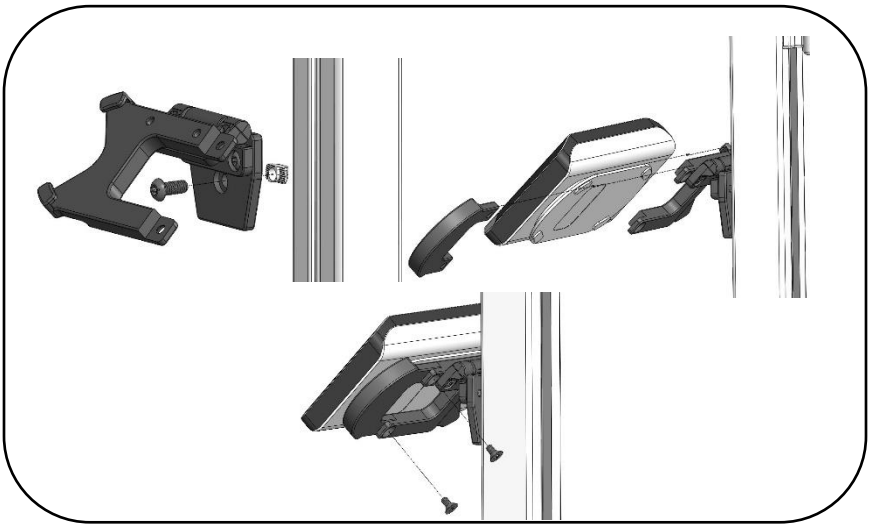

16. BUTTERFLY BRACKET INSTALLATION

- Remove channel cover strip (ref. point 4).
- Slide inner bracket into outer bracket until the two (2) screw holes line up.
- Insert two (2) screws into holes and thread two (2) nuts onto the two (2) screws but keep loose.
- Place Z-Nuts into the extrusion channel, move bracket up or down to desired height.
- Tighten bracket to extrusion with two (2) screws and two (2) Z-Nuts.
- Slide charger onto bracket until firmly in place.

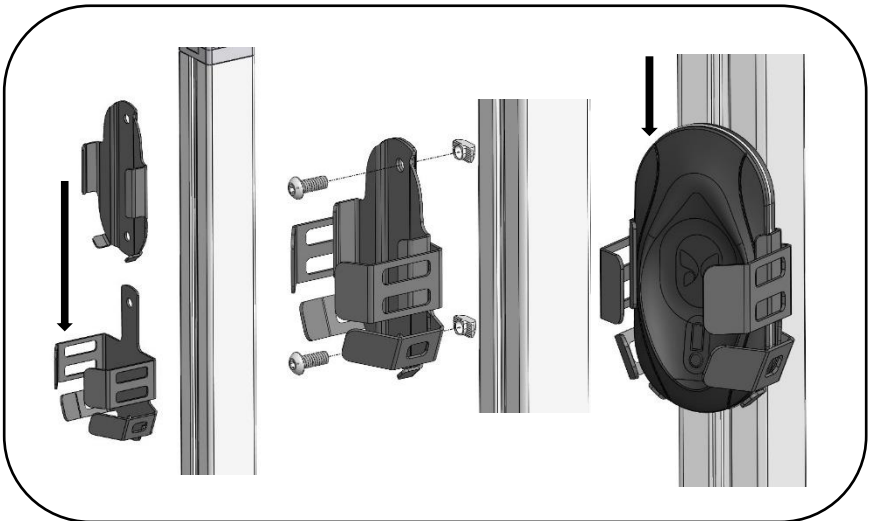

17. JABRA 410/510 – BRACKET & SPEAKER INSTALLATION

- Remove channel cover strip (ref. point 4).
- Remove screw and cap using Torx Security L-Key provided.
- Install Jabra 410 and 510 Bracket to extrusion with screw and Z-Nut.
- Install speaker by sliding speaker ledge into bracket lip with wire either at top or bottom.
- Re-install cap and screw using Torx Security L-Key provided.

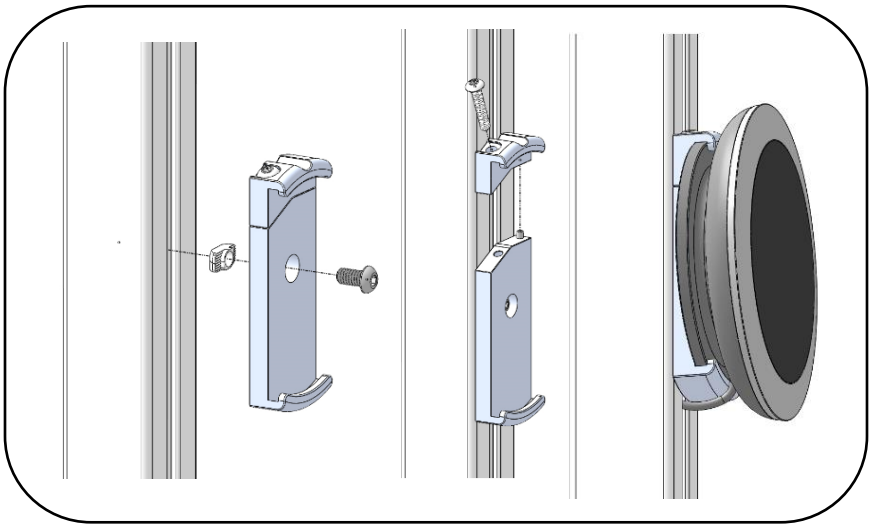

18. JBL CHARGE 4/5 AND FLIP 4/5 – BRACKET & SPEAKER INSTALLATION

- Remove channel cover strip (ref. point 4).
- Install JBL Charge bracket to extrusion with two (2) screws and two (2) Z-nuts.
- Remove screws and cap using Torx Security L-Key provided.
- Install speaker by sliding speaker ledge into bracket lip.
- Re-install cap and screw using Torx Security L-Key provided.

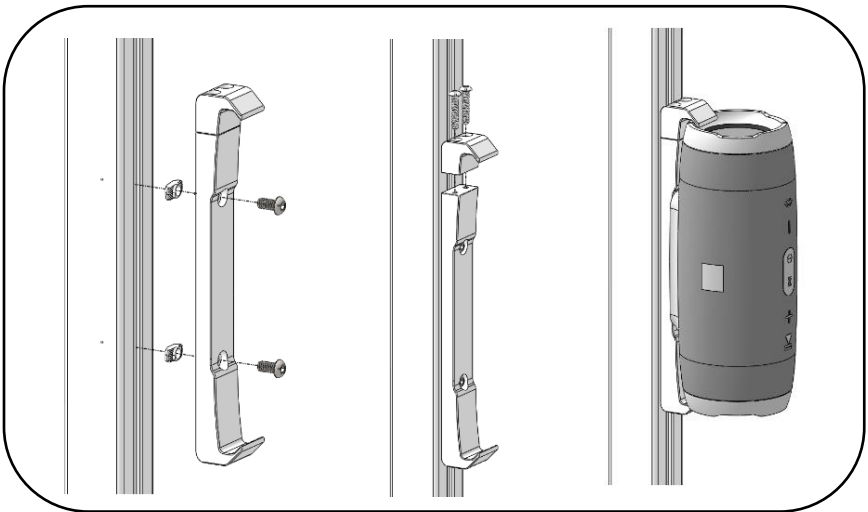

END OF NOVA ASSEMBLY INSTRUCTIONS

For further instructions please visit **Tryten.com/instructions**.

For additional questions or technical support contact us at
Tryten.com/contact or **1-800-860-4455**.

California Proposition 65

This product or its power cord may contain chemicals known to the state of California to cause cancer and birth defects or other reproductive harm. Wash hands after handling.