



# **Tryten Nova Connect Assembly Instructions**

For further instructions please visit **[Tryten.com/instructions](https://tryten.com/instructions)**.

For additional questions or technical support contact us at  
**[Tryten.com/contact](https://tryten.com/contact) or 1-800-860-4455.**

<b>Assembly Instructions</b>	<b>Page</b>
Receiving the Shipping Box	4
Assembling Base to Pole	5
Removing Channel Strips	6
Power Box and Cabling Installation	7
Extension Pole Installation	8
Handle Installation	8
Device Height Adjustment	9
Work Surface Installation	10
Keyboard Tray Installation	11
Nova Connect Vesa Bracket and Monitor Installation	12-13
Nova Connect Camera Bracket Installation	14
Logitech Bracket and Camera Installation	15-16
Poly P15/X30 Mount Installation	17
HD Hinge Installation and Adjustment	18
Transducer Holder Installation	19
Lockable Caddy Installation	20-21
Yeti 200 Battery Bracket Installation	22
Poly SY20 Speaker installation	23
Speaker Bracket and Speaker Installation	24-25
Intel NUC Bracket and Unit Installation	26

## NOVA HARDWARE PACK

- Label Hardware Kit Nova (1)
- Hex L-Key - 3/16" size (1)
- Torx Security L-Key - T25 (1)
- Hex L-Key - 5/32" size (1)
- Screw 10-24 x 3/4" Security Torx, Button head, SS (1)
- Screw 1/4-20 by 1" Socket Head, Zinc (8)
- Belleville (dome) Washer 1/4" 18-8 SS (4)

## ADDITIONAL TOOLS NEEDED FOR INSTALLATION

- Scissors for cutting channel cover to length.

## ASSEMBLY INSTRUCTIONS

Note: Shipping box pictures show Nova Connect Cart for assembly reference. Configurations may vary, but the installation process will be similar.

## INSTALLATION OF ACCESSORIES TO THE CARTS

Note: When installing accessories, the Z or T-Nut has to be loose and aligned vertically (up/down) when inserted into the extrusion channel. Once adjusted at the desired height, tighten the screw until it is fully locked to the extrusion. Always verify that the nut is aligned across the channel (left/right) when fully tightened.



## 1. OPEN THE SHIPPING BOX

- Base.



- Extract Poles.

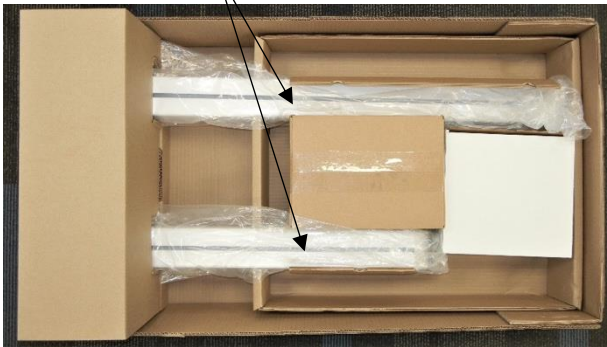

- Extract Accessories.



## 2. ASSEMBLE THE POLE

- Assemble the Pole to the base with the four (4) screws and dome washers using the 3/16" Hex L-Key from the hardware pack.

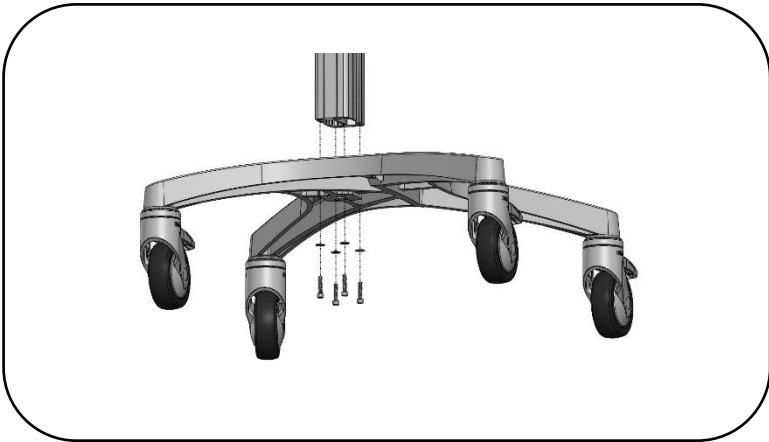
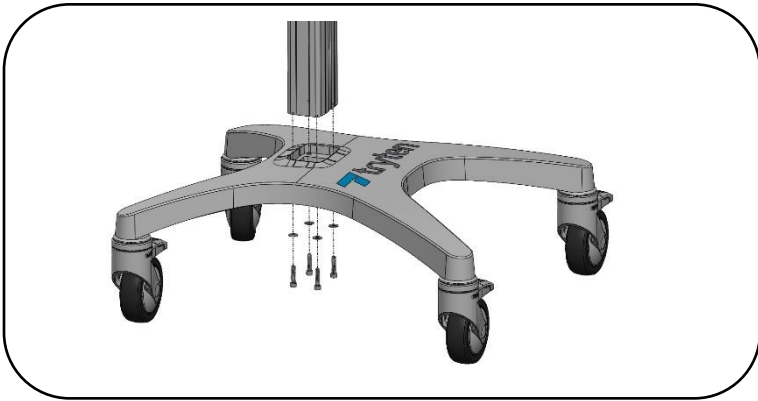

### 3. REMOVE THE CHANNEL STRIPS

- Insert one (1) of the smaller Allen L-Keys or similar devices in behind the top of the channel cover to pull out of the pole slot. Reinstall covers after the power cords are in place.

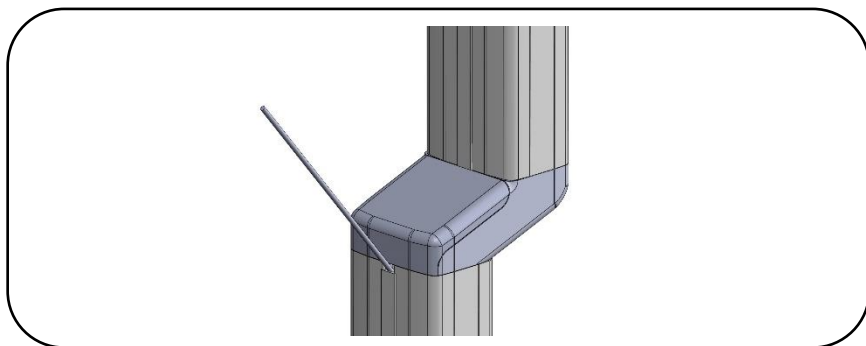

***Note: Channel Cover Strips will need to be adjusted if accessories are installed.***

#### 4. POWER BOX AND CABLING INSTALLATION

- Install Utility box by loosening the T-Nuts, insert T-Nuts to the extrusion channel, slide box up or down to desired height and tighten screws.
- Open box by using Torx Security L-Key, loosen two (2) screws from the back of the Power Box until door swings open.
- Install 9' Green Dot Hospital Grade Power Extension Cable as shown (see middle image).
- Install tablet's power cable through hole and up the channel as shown.
- Close door back in place and re-install the screws from back.

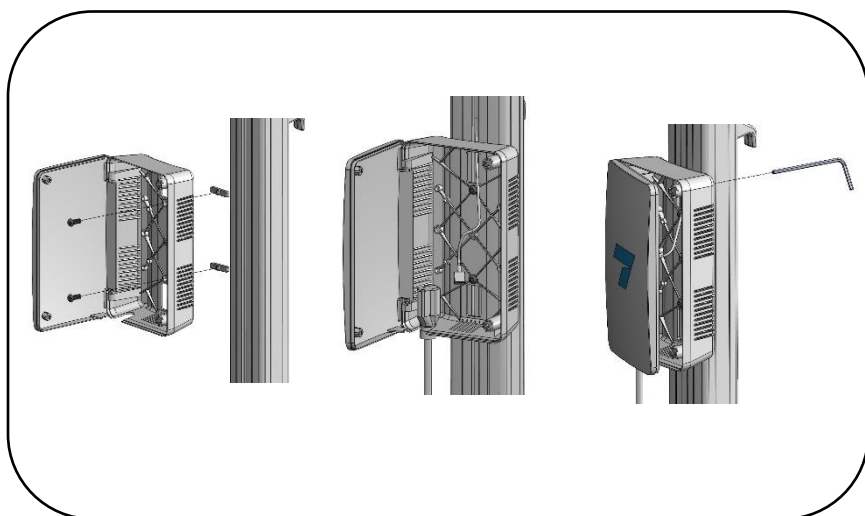

#### STORING THE POWER CORD

When the cart is not in use, or device is not being charged, the extension cord should be wrapped and stored on the unit. Wrap the cable firmly around the upper and lower cord wraps located on the back of the unit pole.

## 5. EXTENSION POLE INSTALLATION, NOVA CONNECT

- On the Nova Connect, shown below, assemble the offset adapter to the main extrusion with the four (4) screws (1") using the 3/16" Allen L-Key.

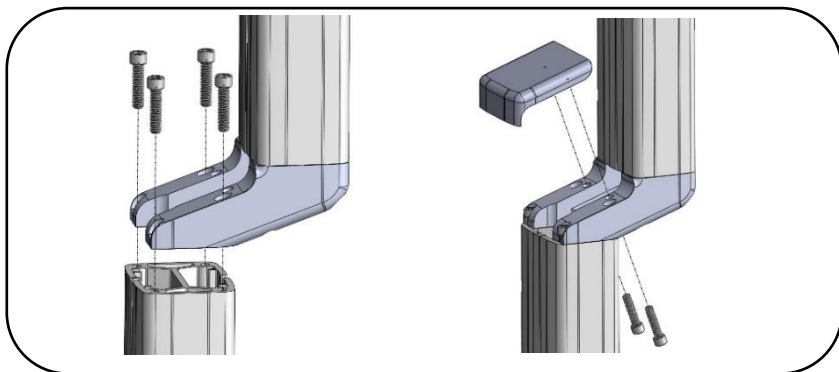

## 6. HANDLE INSTALLATION

- Install Handle by loosening the T-Nut, insert T-Nut into the extrusion channel, slide handle up or down to desired height and tighten screw.

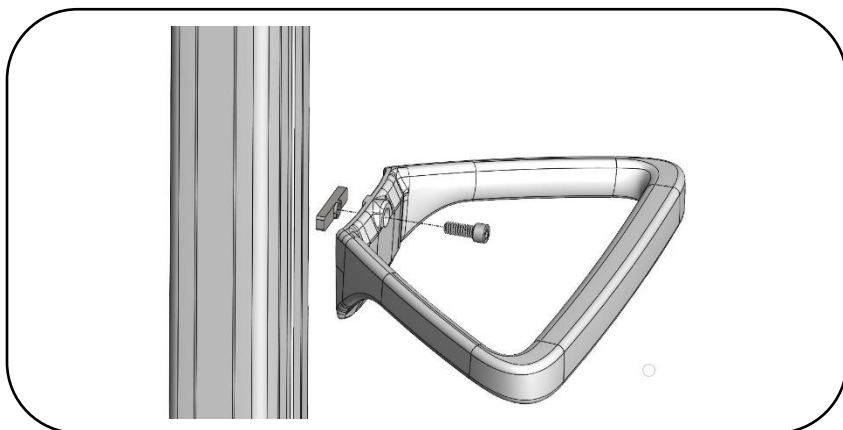



## 7. DEVICE HEIGHT ADJUSTMENT

- In order to adjust the height of the surface or keyboard tray, the handle may need to rotate to add more turns. The handle is spring loaded so it can be rotated to a different position to tighten the assembly. With assembly loose, move assembly to desired height. Tighten the handle and lock the device in place by turning the handle clockwise. If the handle cannot turn anymore and the assembly is not yet tight, pull the handle out (image 1), rotate counterclockwise and release handle back in place (image 3) to tighten the assembly. Repeat process until device is fully tightened.
- Work Surface adjustment

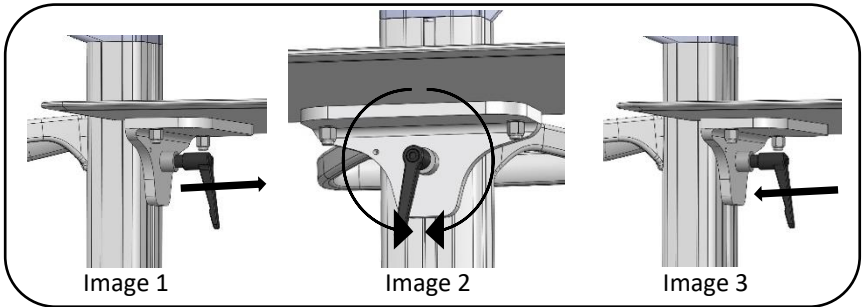

- Keyboard Tray adjustment

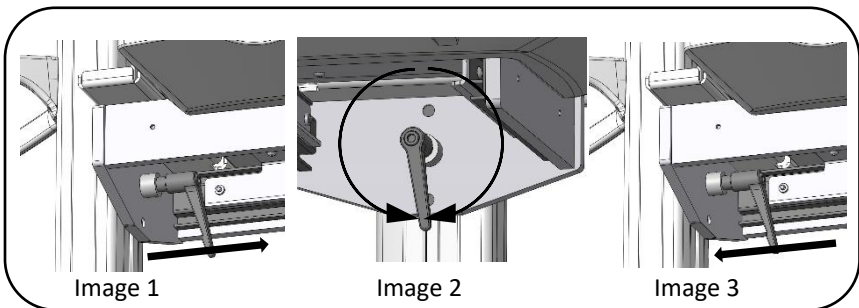

## 8. NOVA CONNECT – WORK SURFACE INSTALLATION

- Remove channel cover strip (ref. point 3).
- Remove two (2) screws from underneath to remove offset adapter cap using L-Key provided.

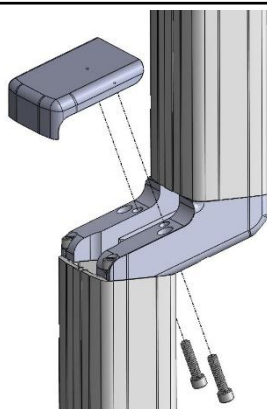

- Slide Work Surface down channel from top, set and lock with handle at desired height (ref. point 7).
- Re-install offset adapter cap.

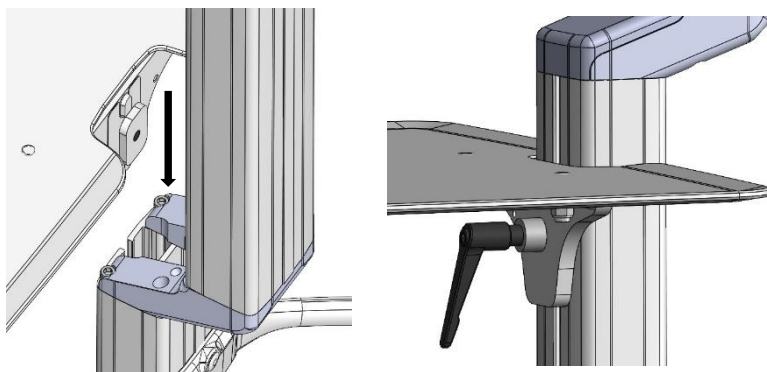

## 9. NOVA CONNECT - KEYBOARD TRAY INSTALLATION

- Remove channel cover strip (ref. point 3).
- Remove two (2) screws from underneath to remove offset adapter cap using L-Key provided.

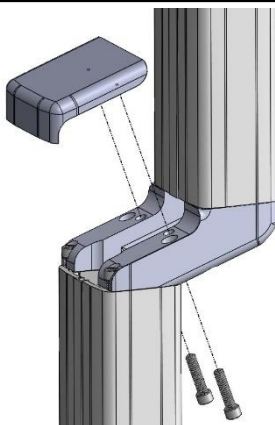

- Slide Keyboard Tray down channel from top, set and lock with handle at desired height (ref. point 7).
- Re-install offset adapter cap to pole.

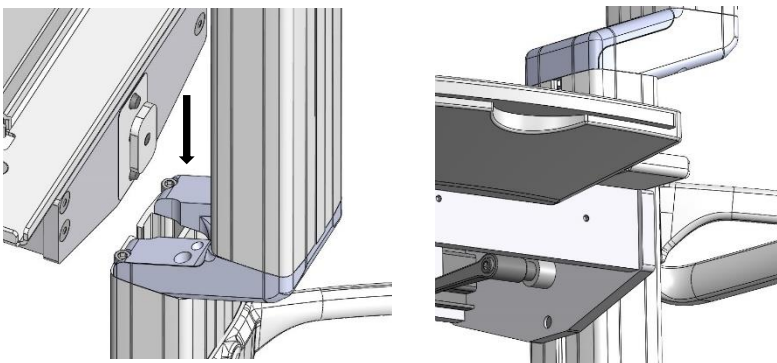

## 10. NOVA CONNECT– FIXED VESA BRACKET & MONITOR INSTALLATION

- Remove channel cover strip (ref. point 3).
- Install bracket to extrusion with two (2) screws and two (2) Z-Nuts.

***Note: Ensure the thicker section of the bracket is mounted at the top***

- Install VESA plate to bracket with four (4) button head screws.
- Install Monitor to VESA plate with four (4) mounting screws (not included).

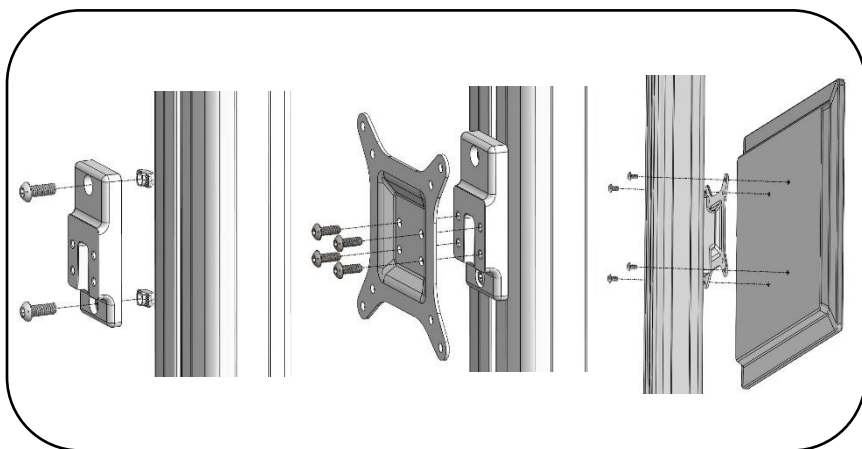

## 11. NOVA CONNECT– TILTING VESA BRACKET & MONITOR INSTALLATION

- Remove channel cover strip (ref. point 3).
- Install bracket to extrusion with two (2) screws and two (2) T-Nuts.

***Note: Ensure the thicker section of the bracket is mounted at the top FOR ALL VESA BRACKETS***

- Install Monitor to VESA plate with four (4) mounting screws (not included).

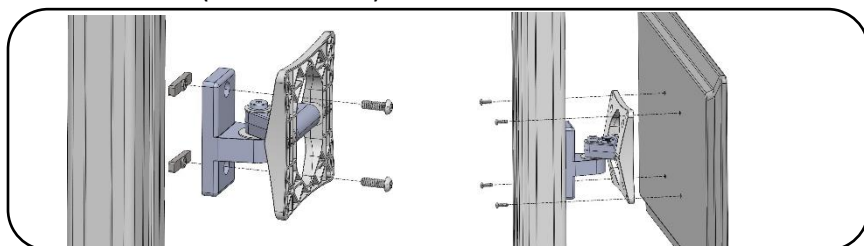

## 12. NOVA CONNECT– ARTICULATING VESA BRACKET & MONITOR INSTALLATION

- Remove channel cover strip (ref. point 3).
- Install bracket to extrusion with two (2) screws and two (2) Z-Nuts.
- Remove two (2) cover screws using Torx Security L-Key.
- Rotate plastic cover to install Monitor to VESA plate with four (4) mounting screws (not included).
- Re-install two (2) cover screws.

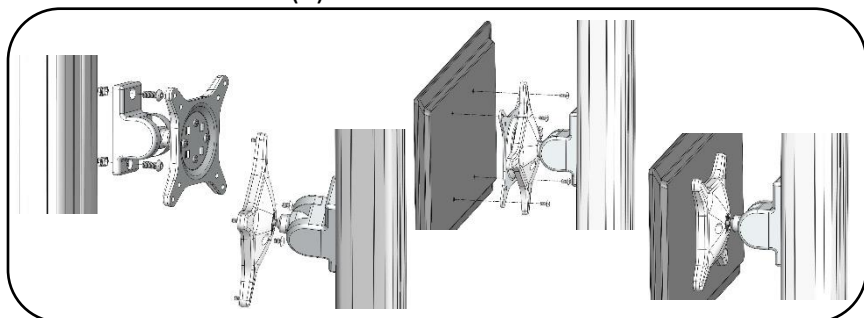

### 13. NOVA CONNECT– UNIVERSAL ANGLE BRACKET & CAMERA INSTALLATION

- Remove channel cover strip (ref. point 3).
- Install camera bracket to extrusion with two (2) screws and two (2) T-Nuts.
- Align the alignment hole on camera with protruding alignment screw on bracket.
- Use screw and Allen L-Key provided to install camera on bracket.
- Remove alignment screw and install from opposite side to mount camera opposite way.

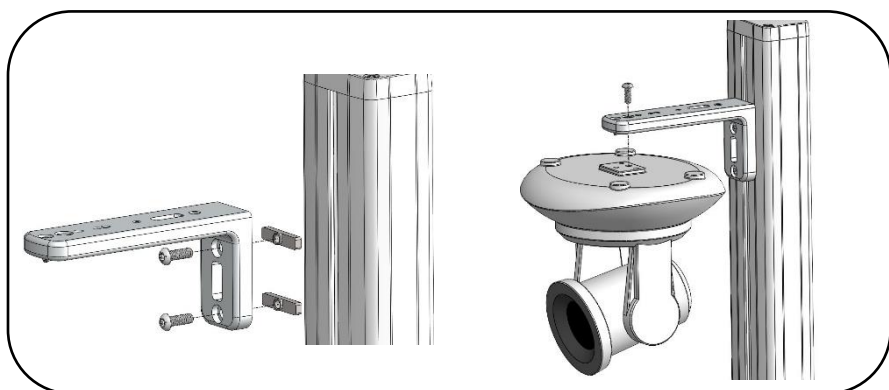

## 14. NOVA CONNECT - LOGITECH MEETUP & RALLY, FIXED BRACKET – BRACKET & CAMERA INSTALLATION

- Remove channel cover strip (ref. point 3).
- Install Logitech bracket to extrusion with one (1) screw and (1) Z-Nut.
- Remove screws and cap with Allen L-Key provided.
- Install camera by placing camera slot over bracket ledge.
- Re-install screws and cap with Allen L-Key provided.

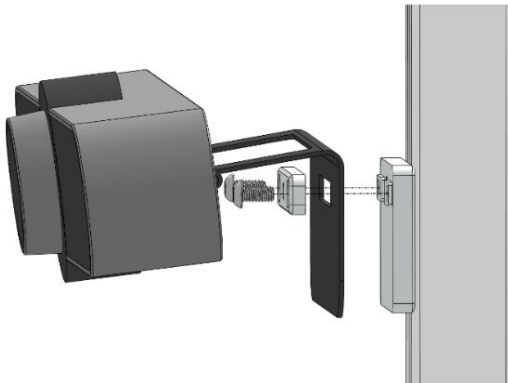
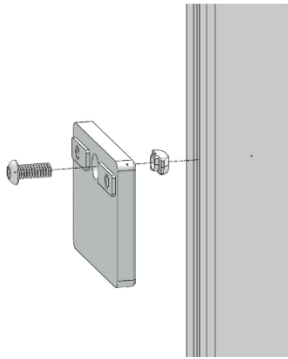

## 15. NOVA CONNECT - LOGITECH MEETUP & RALLY, 180 PAN BRACKET – BRACKET & CAMERA INSTALLATION

- Remove channel cover strip (ref. point 3).
- Install Logitech bracket to extrusion with two (2) screws and two (2) Z-Nuts.
- Remove screws and cap with Allen L-Key provided.
- Install camera by placing camera slot over bracket ledge.
- Re-install screws and cap with Allen L-Key provided.

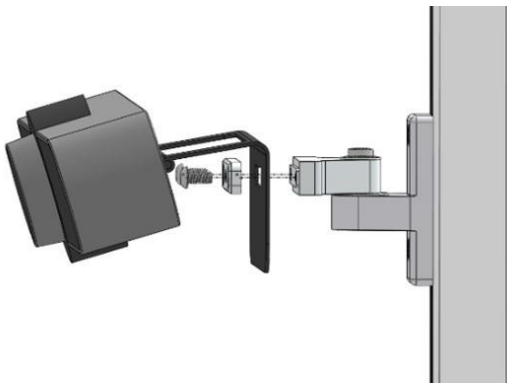
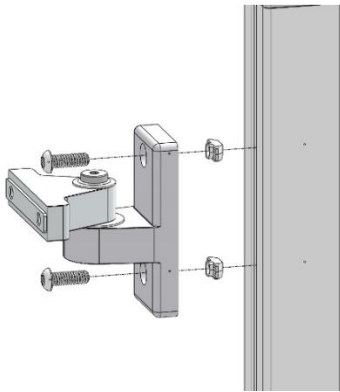



## 16. NOVA CONNECT - POLY P15/X30 MOUNT INSTALLATION

- Remove channel cover strip (ref. point 3).
- Loosen T-Nut but do not remove, insert T-Nut into the extrusion channel, move bracket up or down to desired height.
- Tighten bracket to extrusion with screw and T-Nut.
- Install camera/speaker, as per example, as shown.

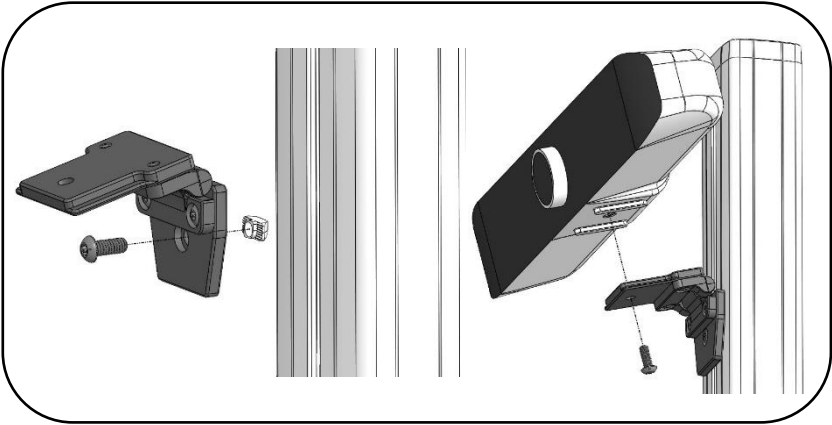

- To adapt the mount from P15 to X30 or reverse, undo two (2) screws from hinge and flip plate over, re-install two (2) screws.

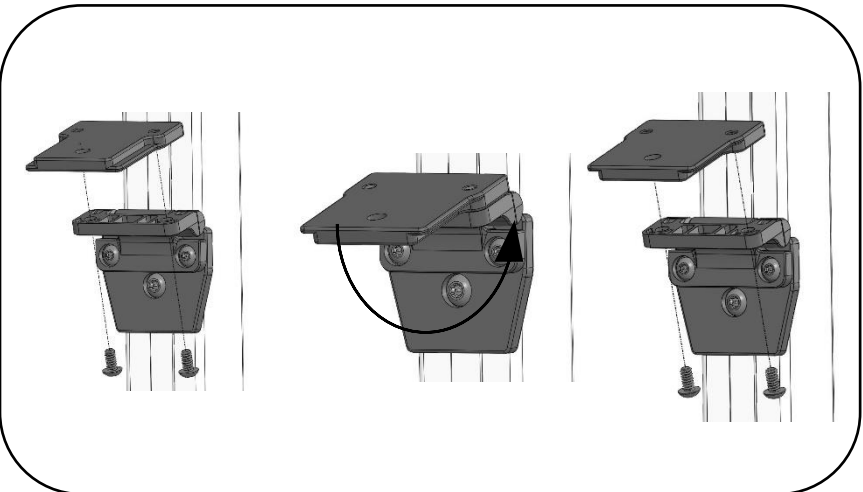

## 17. NOVA CONNECT - HD HINGE INSTALLATION AND ADJUSTMENT

- Remove channel cover strip (ref. point 3).
- Install HD Hinge to extrusion by having two (2) screws and T-Nuts loose, insert into extrusion channel, move up or down to desired position and tighten screws.
- To adjust, rotate handle CCW to loosen just enough to rotate hinge up or down to desired angle, rotate handle CW to tighten.
- To adjust handle, refer to point 7.

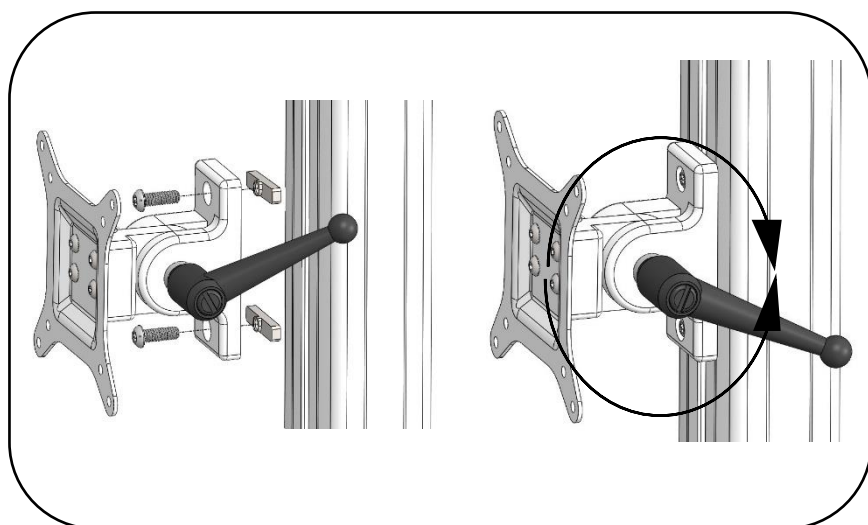

## 18. NOVA CONNECT - TRANSDUCER HOLDER INSTALLATION

- Remove channel cover strip (ref. point 3).
- Install Adapter Block bracket to extrusion by having two (2) screws and T-Nuts loose, insert into extrusion channel, move up or down to desired position and tighten screws.
- Attach plastic pole attachment to Adapter Block by using two (2) screws as shown.
- Slide Transducer Holder down from top onto pole attachment taper until it 'clicks' into place.

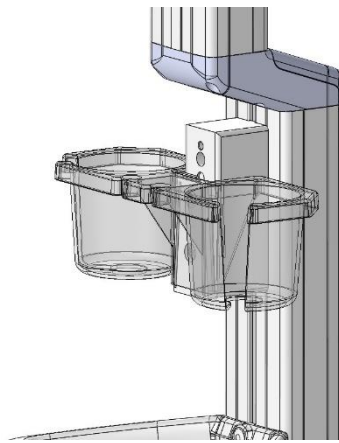
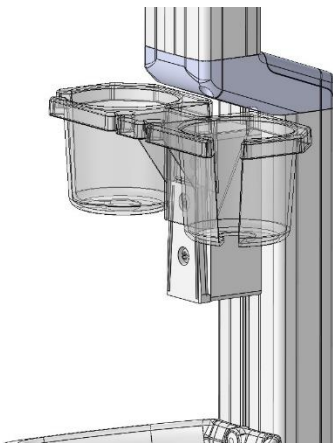
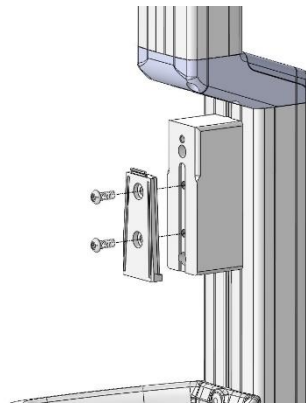
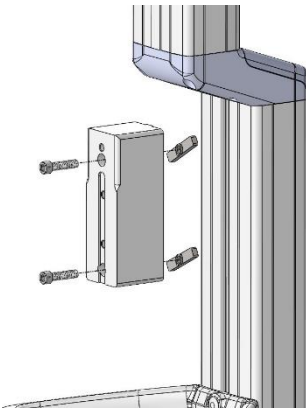

## 19. NOVA CONNECT - LOCKABLE CADDY INSTALLATION

- Remove channel cover strip (ref. point 3).
- Install Adapter Block bracket to extrusion by having two (2) screws and T-Nuts loose, insert into extrusion channel, move up or down to desired position and tighten screws.
- Attach plastic pole attachment to Adapter Block by using two (2) screws as shown.
- Slide Caddy down from top onto pole attachment taper until it 'clicks' into place.

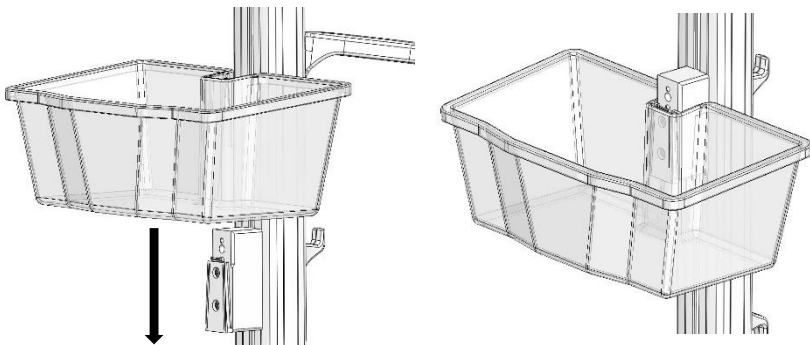
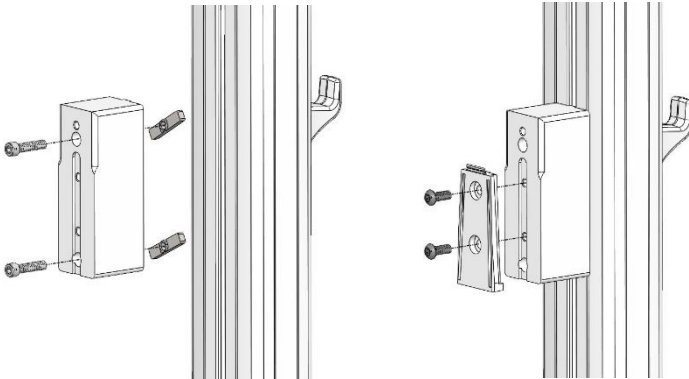

- Lower Lockable Lid assembly onto Caddy as shown.
- Install Lockable Lid assembly with screw as shown.

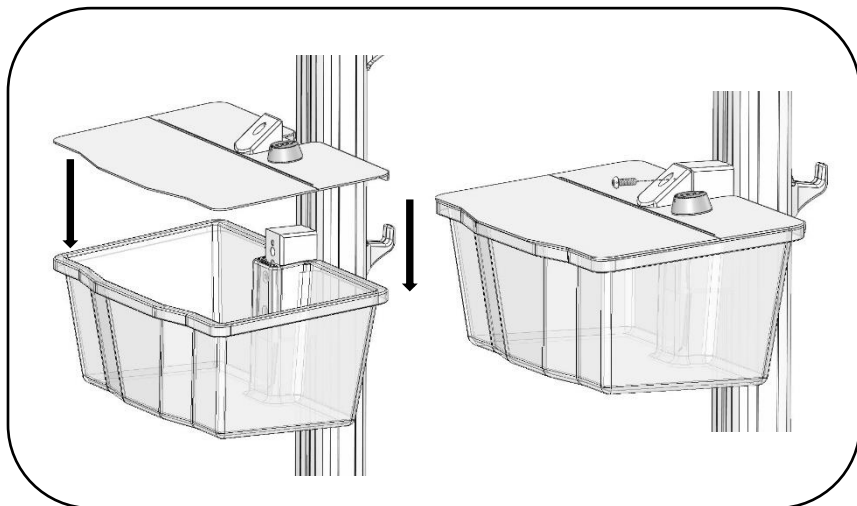

## 20. NOVA CONNECT - YETI 200 BRACKET INSTALLATION

- Remove channel cover strip (ref. point 3).
- Install Yeti 200 platform bracket to extrusion by having two (2) screws and T-Nuts loose, insert into extrusion channel, move up or down to desired position and tighten screws.
- Place battery on platform.
- Place handle bracket around the green handle as the Z-Nut is inserted into the channel, place bracket on battery and tighten screw.

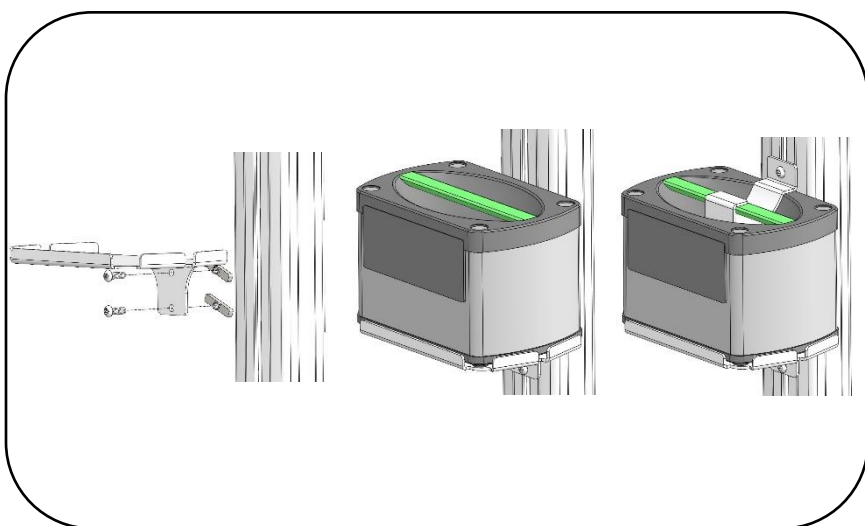

## 21. NOVA CONNECT - POLY SY20 SPEAKER INSTALLATION

- Remove channel cover strip (ref. point 3).
- Loosen T-Nut but do not remove, place T-Nut into extrusion channel, move bracket up or down to desired height.
- Tighten bracket to extrusion with screw and T-Nut.
- Slide speaker back ridge into the fixed bracket, slide clamp bracket onto speaker and align two (2) screw holes.
- Install and tighten two (2) screws.

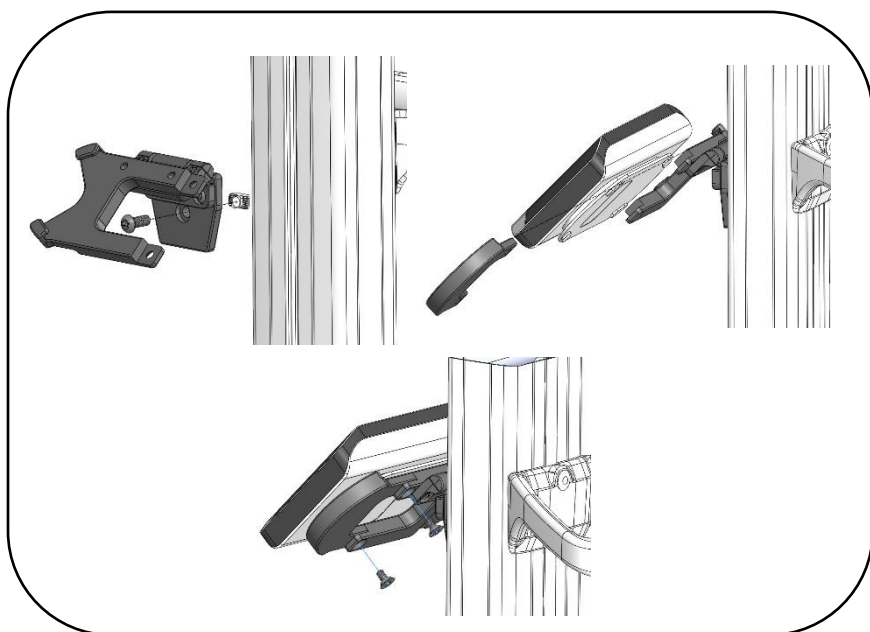

## 22. JABRA 410/510 – BRACKET & SPEAKER INSTALLATION

- Remove channel cover strip (ref. point 3).
- Remove screw and cap using Torx Security L-Key provided.
- Install Jabra 410 and 510 Bracket to extrusion with screw and Z-Nut.
- Install speaker by sliding speaker ledge into bracket lip with wire either at top or bottom.
- Re-install cap and screw using Torx Security L-Key provided.

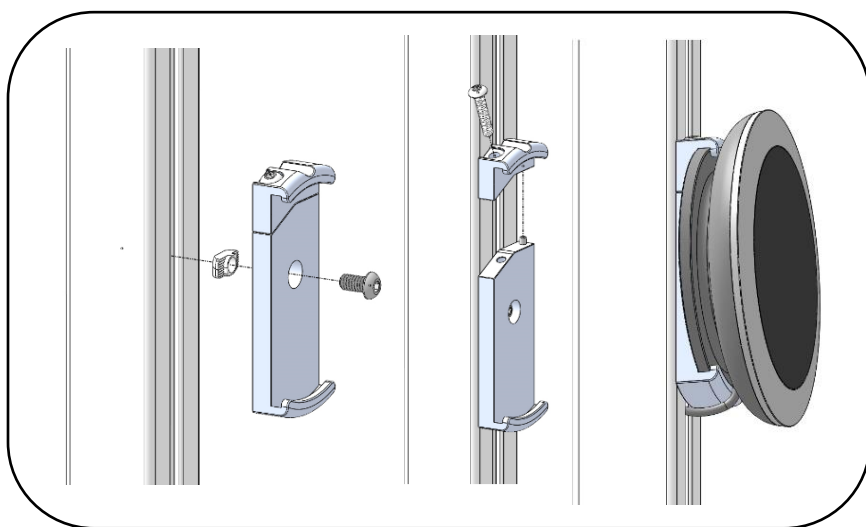



## 23. JBL CHARGE 4/5 AND FLIP 4/5 – BRACKET & SPEAKER INSTALLATION

- Remove channel cover strip (ref. point 3).
- Install JBL Charge bracket to extrusion with two (2) screws and (2) Z-Nuts.
- Remove screws and cap using Torx Security L-Key provided.
- Install speaker by sliding speaker ledge into bracket lip.
- Re-install cap and screw using Torx Security L-Key provided.

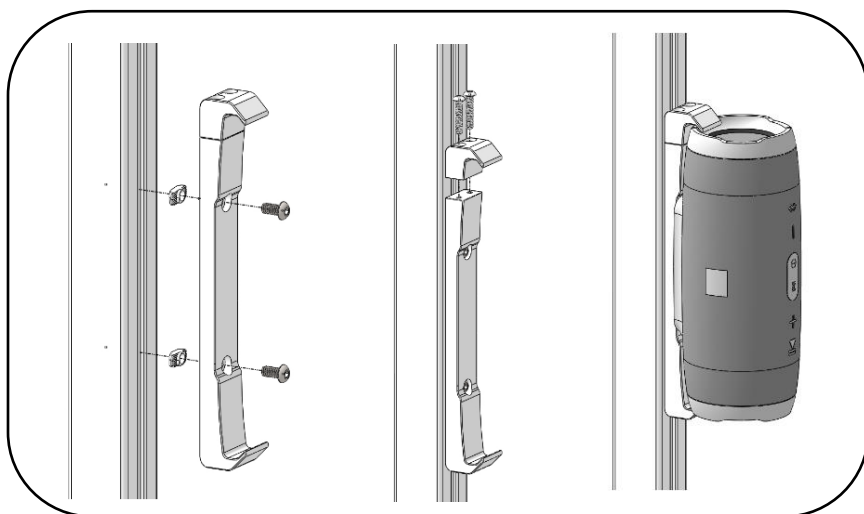

## 24. INTEL NUC – BRACKET & UNIT INSTALLATION

- Remove channel cover strip (ref. point 3).
- Install Intel NUC bracket to extrusion with screw and Z-Nut.
- Install Intel NUC by lining up holes of bracket and unit.
- Install two (2) screws with L-Key provided.

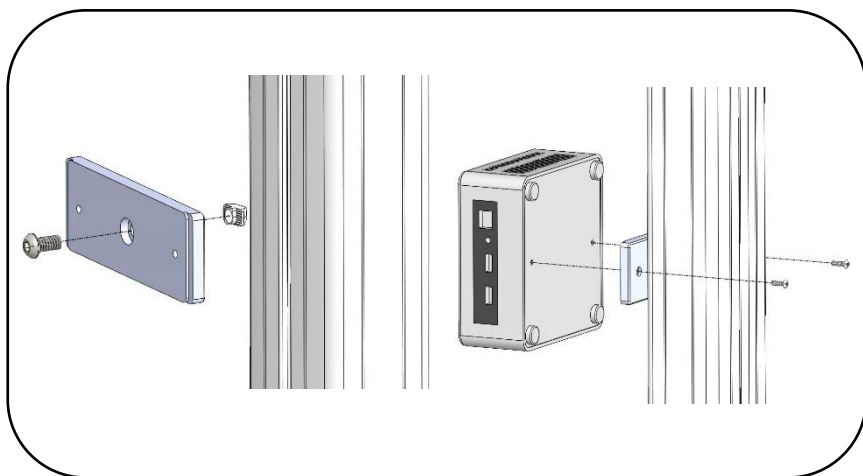

## END OF NOVA CONNECT ASSEMBLY INSTRUCTIONS

For further instructions please visit **[Tryten.com/instructions](https://www.tryten.com/instructions)**.

For additional questions or technical support contact us at  
**[Tryten.com/contact](https://www.tryten.com/contact) or 1-800-860-4455.**

### California Proposition 65

This product or its power cord may contain chemicals known to the state of California to cause cancer and birth defects or other reproductive harm. Wash hands after handling.