



# **Tryten Nova Line Assembly Instructions**

For further instructions please visit **[Tryten.com/instructions](https://tryten.com/instructions)**, for additional questions or technical support contact us at **[Tryten.com/contacts](https://tryten.com/contacts)** or **1-800-860-4455**.

<b>Assembly Instructions</b>	<b>Page</b>
Receiving the Shipping Box	3-4
Assembling Base to Pole	5
Universal Omnitab Adjustment	6-9
Removing Channel Strips	10
Nova Go Universal Omnitab Installation	10
Power Box and Cabling Installation	11
Extension Pole installation, Neo and Connect	12
Work Surface Installation	13-15
Keyboard Tray Installation	16
Supply Caddy and Transducer Holder Installation	17
Supply Caddy Lockable Lid	18-19
Nova Connect and Tall Vesa bracket and Monitor Installation	20-21
Nova Neo Vertical Tablet Arm Installation	22
Nova Go and Pro Vesa Plate Installation	22
Nova Connect and Tall Camera Bracket Installation	23-24
Logitech Bracket and Camera Installation	25-26
Speaker Bracket and Speaker Installation	27-29
Intel NUC Bracket and Unit Installation	30

## NOVA HARDWARE PACK

- Felt Pads -  $\frac{3}{4}$ " x  $\frac{1}{8}$ " thick (6)
- Label Hardware Kit Nova (1)
- Hex L-Key -  $\frac{3}{16}$ " size, 3" length (1)
- Torx Security L-Key - T25, 2- $\frac{11}{16}$ " long (1)
- Hex L-Key -  $\frac{5}{32}$ " size, 2- $\frac{11}{16}$ " length (1)
- Keys Set Tablet Cart Nova (1)
- Screw 10-24 x  $\frac{3}{4}$ " Security Torx, Button head, SS (1)
- Screw  $\frac{1}{4}$ -20 by 1" Socket Head, Zinc (4)
- Belleville (dome) Washer  $\frac{1}{4}$ " 18-8 SS (4)

## ASSEMBLY INSTRUCTIONS

Note: Shipping box pictures show Nova Pro Tablet Cart for assembly reference. Alternative configurations vary but the installation process is similar.

### 1. OPEN THE SHIPPING BOX

- Base



Extract the Hardware pack.



- Remove Pole Assembly from packaging.



## 2. ASSEMBLE THE POLE

- Assemble the Pole to the base with the four (4) screws and dome washers using the 3/16" Hex L-Key from the Hardware Pack.

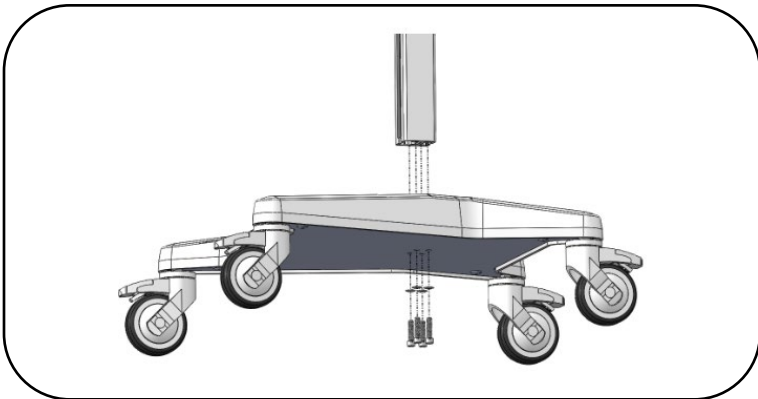
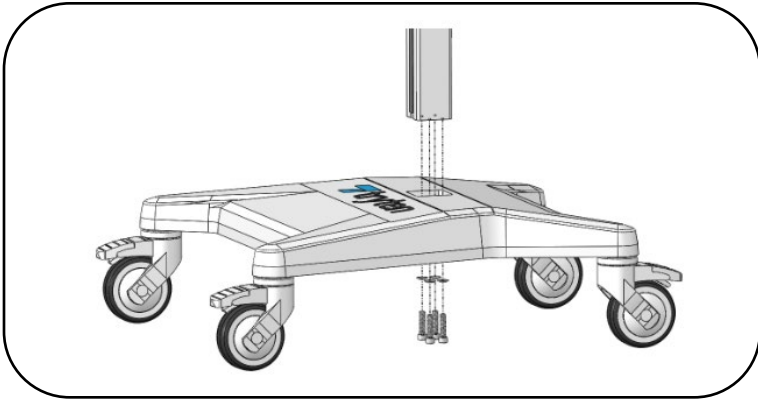

### 3. (A) ADJUST OMNITAB UNIVERSAL BRACKET TO FIT TABLET

The Universal bracket comes adjusted to fit the standard iPad 9.7

- Unlock the Top Slider using the set of keys from the Hardware Pack. Remove the Top Slider from the Universal Bracket.
- Loosen the three (3) screws using the 1/8" Hex L-Key from the front of the cover.

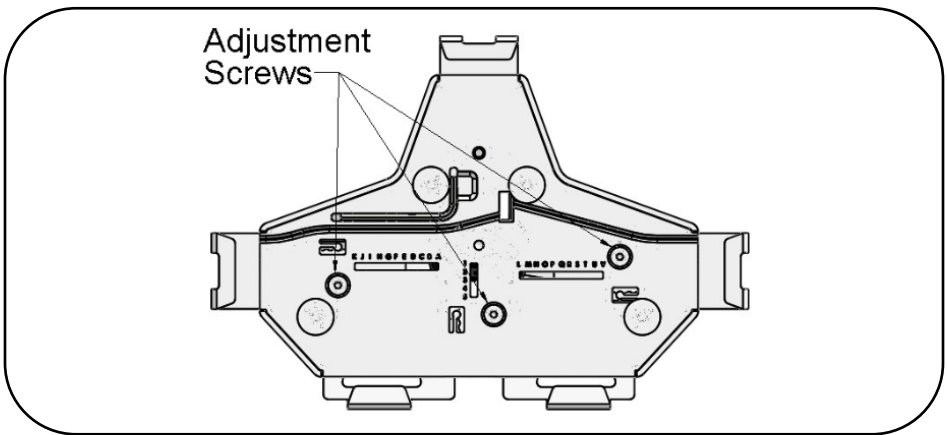

- Pull the sliders to the appropriate size tablet
- Tighten the 3 adjustment screws
- Insert tablet by sliding in from the top.
- Insert the Top Slider until it locks in the tablet and push the locking button.

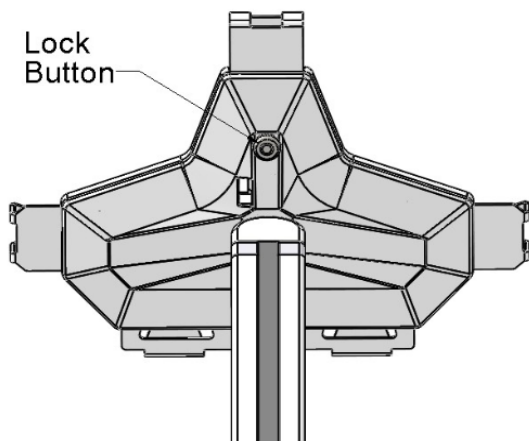

### 3. (B) INSTALLING 2<sup>ND</sup> SET OF SLIDERS WHEN TABLET IN CASE

- Remove the 4 Felt Pads from the Universal Bracket.

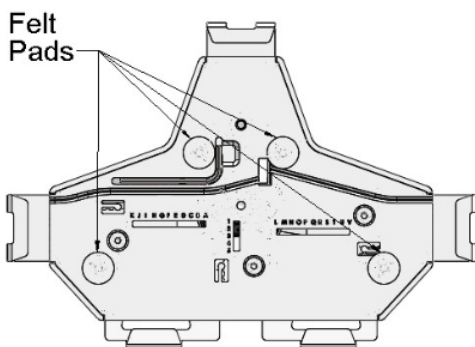

- Remove the 4 Screws holding the cover of the Universal Bracket using the 1/8-inch Hex L-Key from the front of the cover.

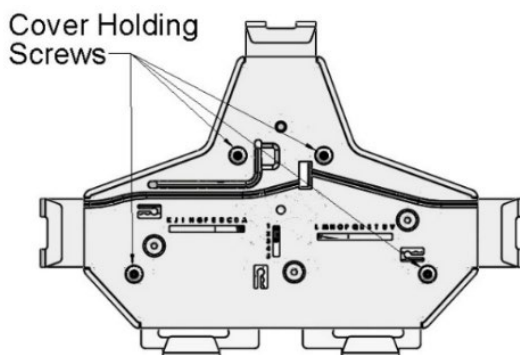

- Remove cover and the 3 screws holding the sliders using the 1/8-inch Hex L-Key from the front of the cover.

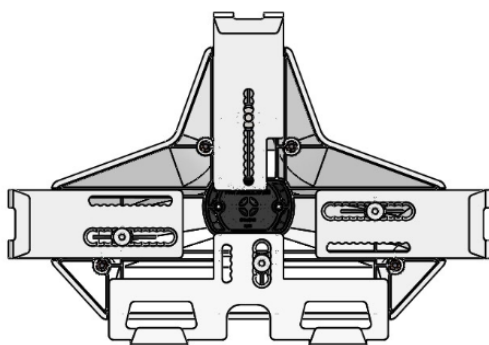

- Remove the 4 sliders and replace with the set of sliders from Hardware Pack.
- Install the 3 Screws holding the sliders using the 1/8-inch Hex L-key from the front of the cover.



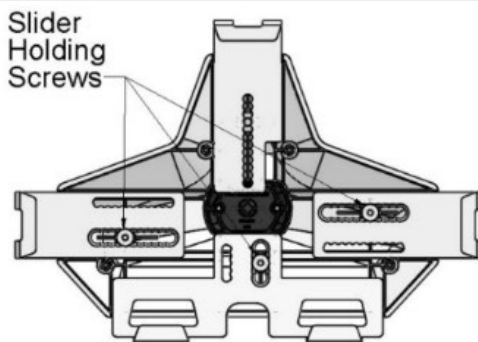

- Put back the cover and install the four (4) screws removed at step b) using the 1/8" Hex L-Key from the front of the cover.
- Apply the set of felt pads supplied in the hardware pack on top of the screws.
- Adjust sliders and install tablet following the instructions from Step 3A

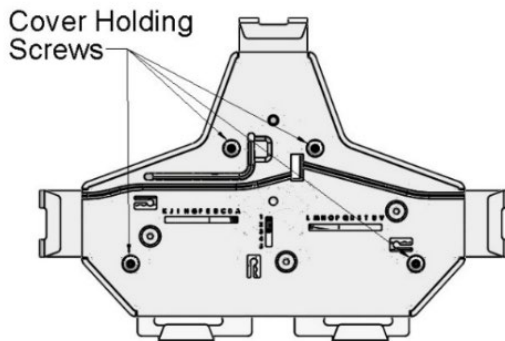

#### 4. REMOVE THE CHANNEL STRIPS

- Insert one of the smaller Allen Keys in behind the top of the channel cover to pull out of the pole. Reinstall covers after the power cords are in place.

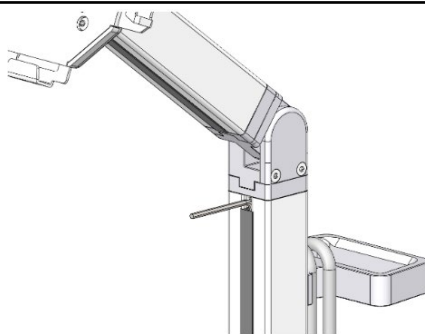

***Note: Channel Cover Strips will need to be adjusted if accessories are installed.***

#### 5. NOVA GO HEAD INSTALLATION

- Extract the Nova Go head from packaging box and the Torx Security Button Head Screw from the Hardware Pack.
- Assemble the Nova Go head as shown using the Torx Security L-Key provided in the Hardware Pack.
- Tighten the screw until it is fully engaged.

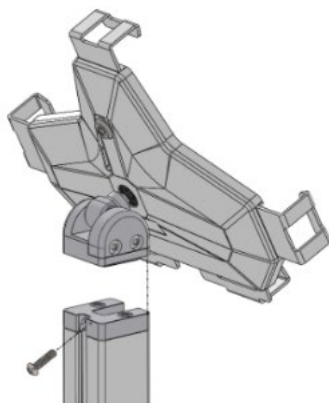

## 6. POWER BOX AND CABLING INSTALLATION

- Open box by using Torx security L-Key, loosen and remove the 2 screws located on the back of the Power Box.
- Lift cover up or down to remove.
- Install 9' Green Dot Hospital Grade Power Extension Cable as shown.
- Install tablet's power cable through hole and up the channel as shown.
- Slide the Power Box Cover back in place and re-install the screws.

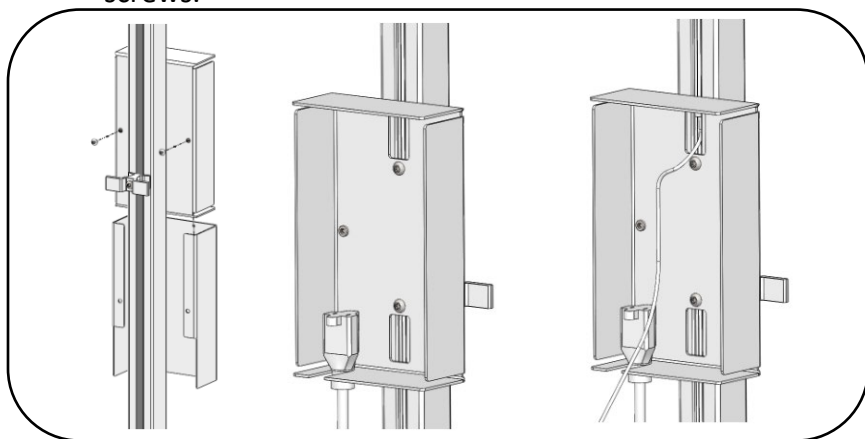

### STORING THE POWER CORD

When the cart is not in use, or tablet is not being charged, the extension cord should be wrapped and stored on the unit. Wrap the cable firmly around the upper handle and lower handle cord wraps located on the back of the unit pole.

## 7. EXTENSION POLE INSTALLATION, NOVA CONNECT AND NOVA NEO

- On the nova connect, shown below left, assemble the extension pole to the offset adapter with the 2 screws (1" using the 3/16" Allen key.
- On Nova Neo, shown below right, assemble with 1 screw using Torx security L-Key provided in hardware pack.

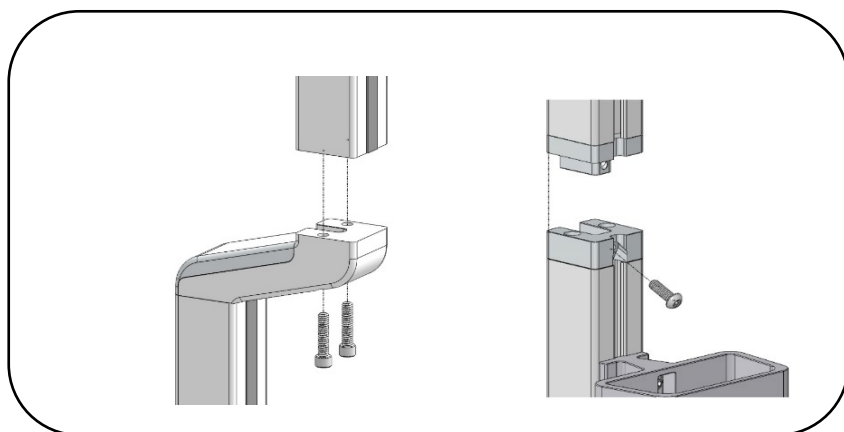

## 8. NOVA PRO AND TALL WORK SURFACE INSTALLATION

- Remove Channel Cover Strip (ref. point 4).
- Remove articulating arm or tall pole with 1 screw using Torx security L-Key provided in hardware pack.
- Remove extrusion adapter by removing (2) ¼" screws with 3/16" L-key provided.



- Slide Work Surface down from top and secure at desired height.
- Reinstall Extrusion Adapter and Arm or tall pole.

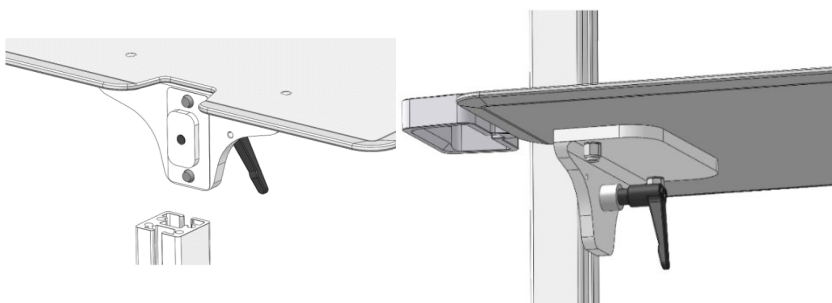

## 9. NOVA MOTION – WORK SURFACE INSTALLATION

- Remove Channel Cover Strip (ref. point 4).
- Remove Pole Cap with rear screw using Torx Security L-Key
- Remove Extrusion Adapter with two (2) screws from top using 3/16" hex L-key
- Slide Work Surface down from top and secure at desired height.

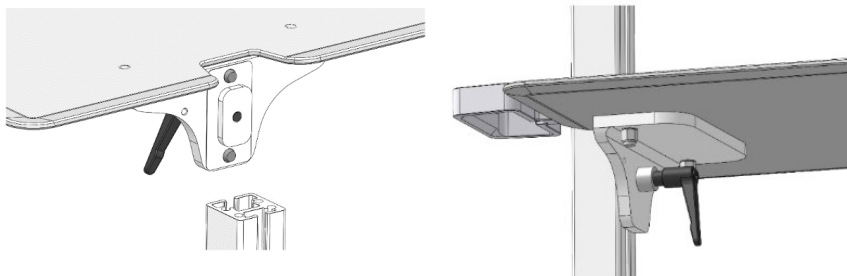
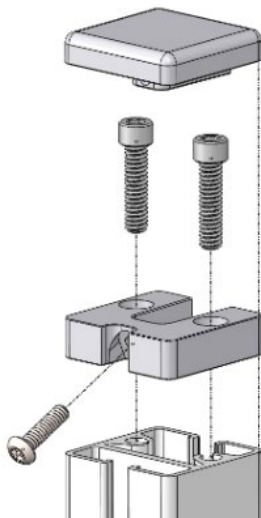

## 10. NOVA CONNECT – WORK SURFACE INSTALLATION

- Remove Channel Cover Strip (ref. point 4).
- Remove two (2) screws from underneath to remove offset adapter cap using Torx security L-key provided.

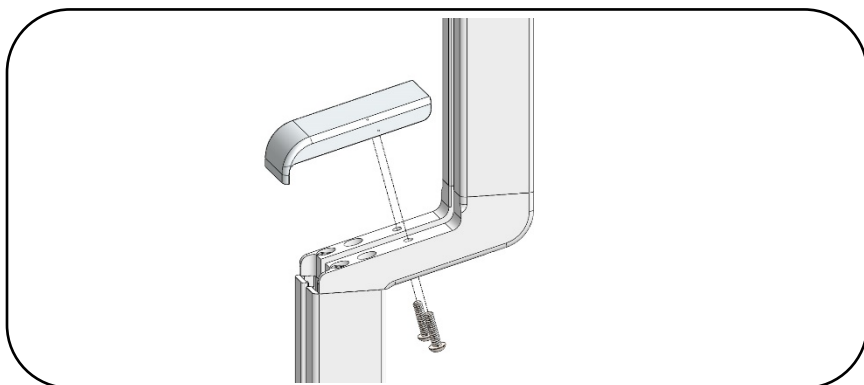

- Slide keyboard tray down channel from top, set and lock with handle at desired height.
- Re-install offset adapter cap.

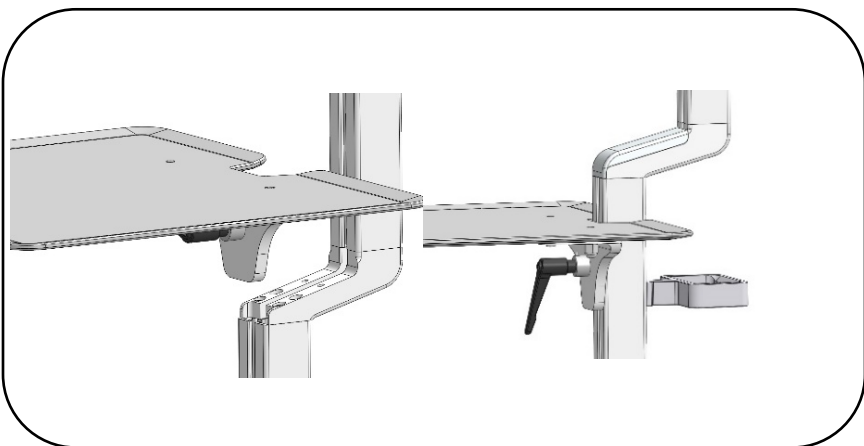

## 11. KEYBOARD TRAY INSTALLATION

- Remove channel cover from front extrusion (ref. step 5).
- Remove two (2) screws from underneath to remove offset adapter cap using Torx Security L-Key provided.

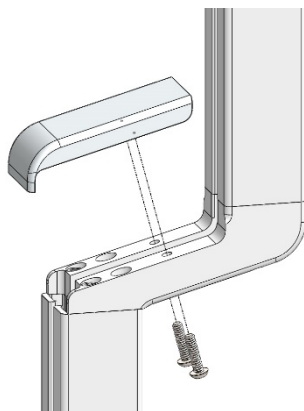

- Slide keyboard tray down channel from top, set and lock with handle at desired height.
- Re-install offset adapter cap to pole.

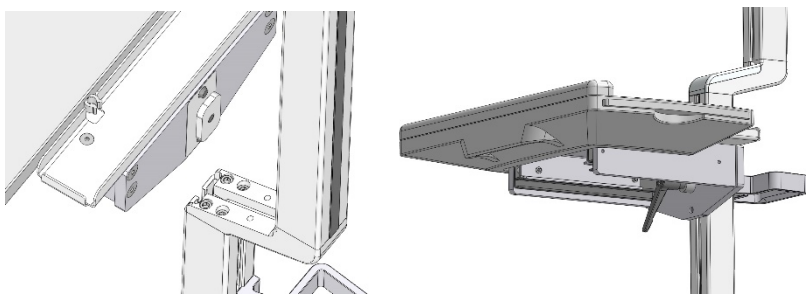



## 12. SUPPLY CADDY & TRANSDUCER HOLDER INSTALLATION

The Supply Caddy and Transducer Holder each come in two (2) parts – the Caddy/Holder and the Mounting Bracket and Hardware to attach to the pole.

- Remove Channel Cover Strip (ref. point 4).
- Install Caddy/Holder bracket with two (2) ¼" Screws and two (2) Z-Nuts as shown below with 5/32" L-key provided in hardware pack.
- Adjust bracket to desired height and tighten screws.
- Slide the Supply Caddy or Transducer Holder onto the Mounting Bracket from above until it snaps in place.

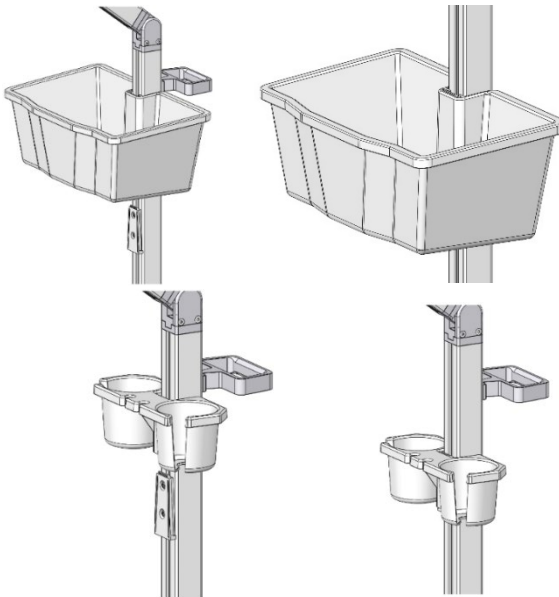
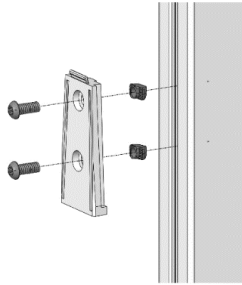

## 12.1 SUPPLY CADDY LOCKABLE LID

- Loosen Z-nut from screw but do not remove.
- Rotate Z-nut so it slides into the channel.
- Lower entire lid until it rests on the Caddy.
- Fasten lid to pole by using Torx security L-key (provided) and turn screw until tight.

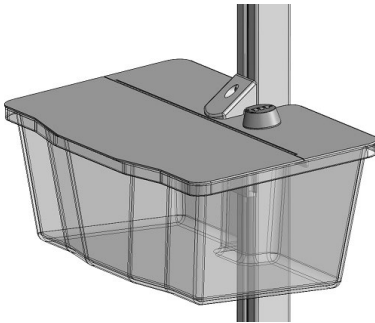
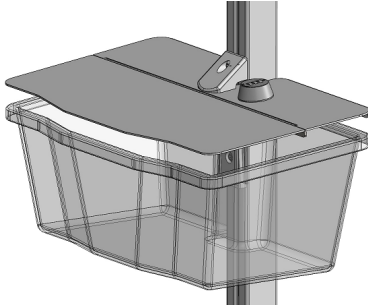

## 12.2 SETTING PERSONAL COMBINATION NUMBERS

- Factory combination is set at 0-0-0
- Combination must be on opening numbers prior to resetting.
- You will find a hole on the outer ring for code reset, see picture.
- Rotate lock until reset button comes into view.
- Push pin with paper clip or small pin and keep it pushed in.
- Set numbers to desired combination.
- Release button and your new combination is set.

To lock, rotate to 'locked' position, rotate one or more dials.

To unlock, rotate dials to personal combination and 'unlock'.

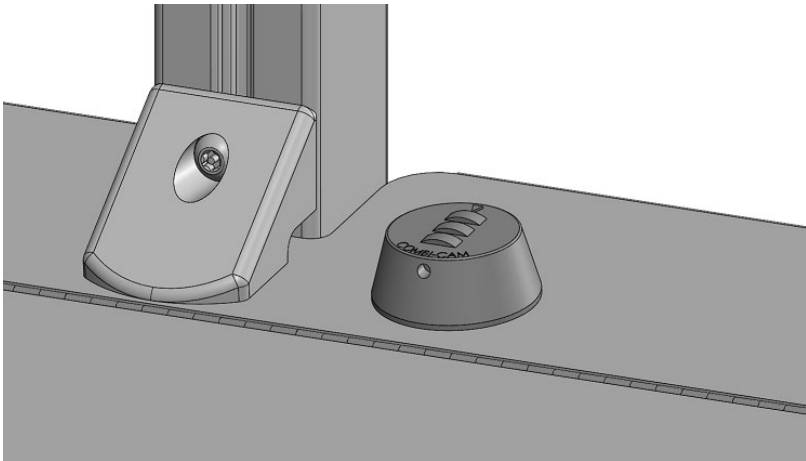

### 13. NOVA CONNECT & TALL – FIXED VESA BRACKET & MONITOR INSTALLATION

- Remove Channel Cover Strip (ref. point 4).
- Install bracket to extrusion with two (2) screws and two (2) Z-Nuts.

***Note: Ensure the thicker section of the bracket is mounted at the top***

- Install VESA plate to bracket with four (4) button head screws.
- Install Monitor to VESA plate with four (4) mounting screws (not included).

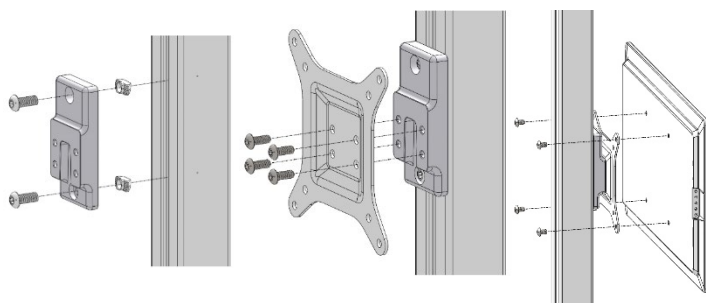

## 14. NOVA CONNECT & TALL – TILTING VESA BRACKET & MONITOR INSTALLATION

- Remove Channel Cover Strip (ref. point 4).
- Install bracket to extrusion with two (2) screws and two (2) Z-Nuts.

***Note: Ensure the thicker section of the bracket is mounted at the top FOR ALL VESA BRACKETS***

- Install VESA plate to bracket with four (4) button head screws.
- Install Monitor to VESA plate with four (4) mounting screws (not included).

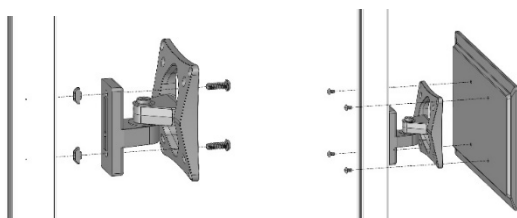

## 15. NOVA CONNECT & TALL – ARTICULATING VESA BRACKET & MONITOR INSTALLATION

- Remove Channel Cover Strip (ref. point 4).
- Install bracket to extrusion with (2) screws and (2) Z-Nuts.
- Remove 2 cover screws using Torx Security L-Key
- Rotate plastic cover to install Monitor to VESA plate with four (4) mounting screws (not included).
- Re-install 2 cover screws

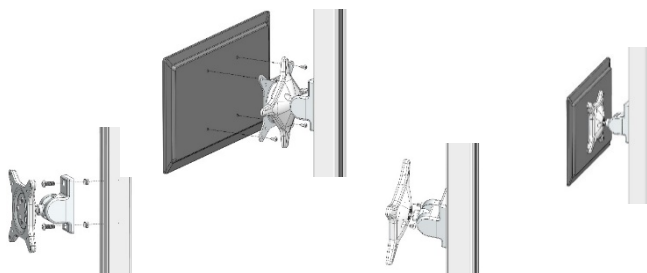

## 16. NOVA NEO – VERTICAL TABLET ARM INSTALLATION

- Remove Channel Cover Strip (ref. point 4).
- Install Adapter Plate to extrusion with two (2) screws and two (2) Z-Nuts provided.

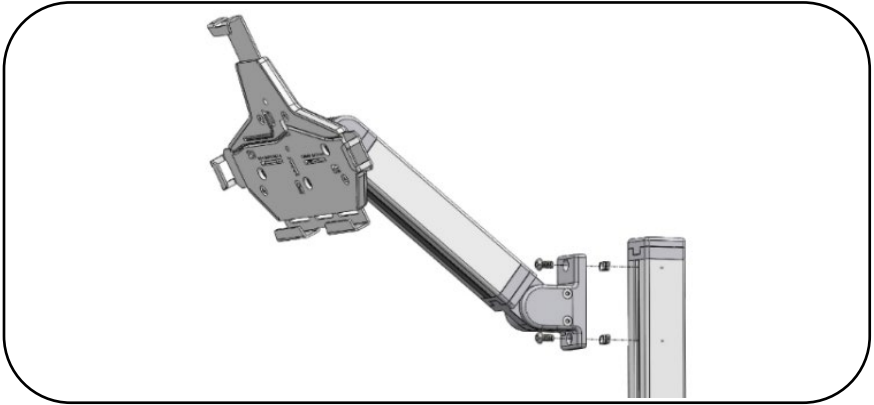

## 17. NOVA PRO/GO VESA – VESA PLATE INSTALLATION

- Install VESA Mount Plate to adapter with four (4) Button-Head Screws.
- Install monitor or device to VESA Plate with four (4) mounting screws (not included).

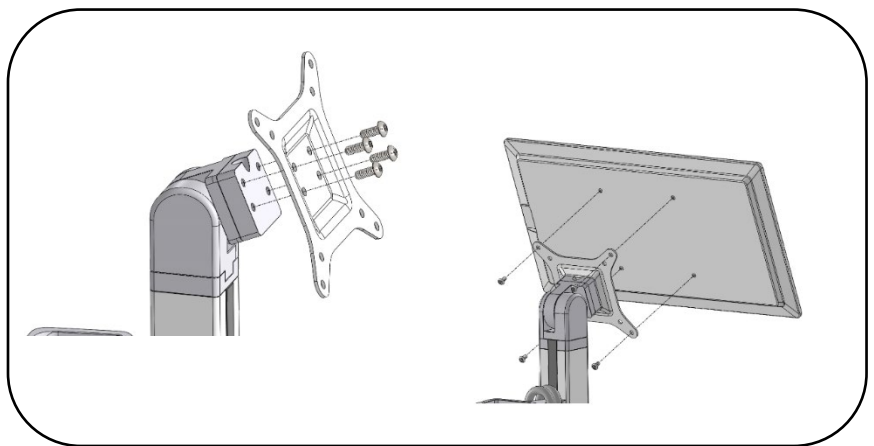

## 18. NOVA CONNECT & TALL – UNIVERSAL ANGLE BRACKET & CAMERA INSTALLATION

- Remove Channel Cover Strip (ref. point 4).
- Install camera bracket to extrusion with two (2) screws and two (2) Z-Nuts.
- Align the alignment hole on camera with protruding alignment screw on bracket.
- Use screw and Allen key provided to install camera on bracket.
- Remove alignment screw and install from opposite side to mount camera opposite way.

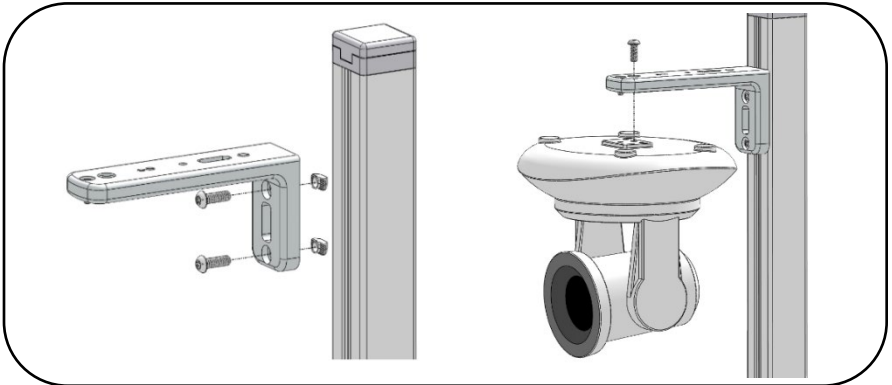

## 19. NOVA CONNECT & TALL – FIXED CAMERA BRACKET & CAMERA INSTALLATION

- Remove Channel Cover Strip (ref. point 4).
- Remove cap and adapter with Allen key provided (if necessary).
- Install fixed camera bracket using two (2) ¼" cap screws.
- Align the alignment hold on camera with protruding alignment screw on bracket.
- Use screw and Allen key provided to install camera on bracket, remove alignment screw and install from opposite side to mount camera opposite way.

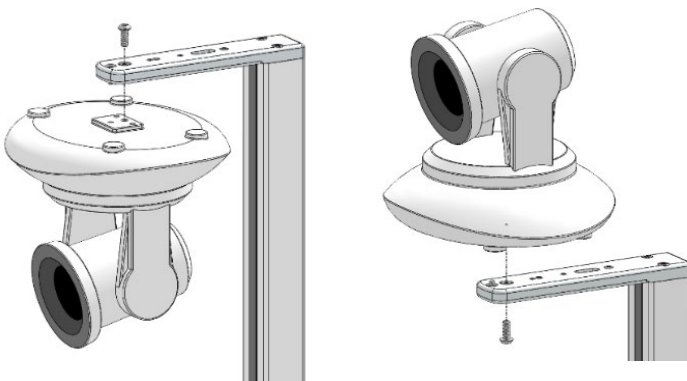
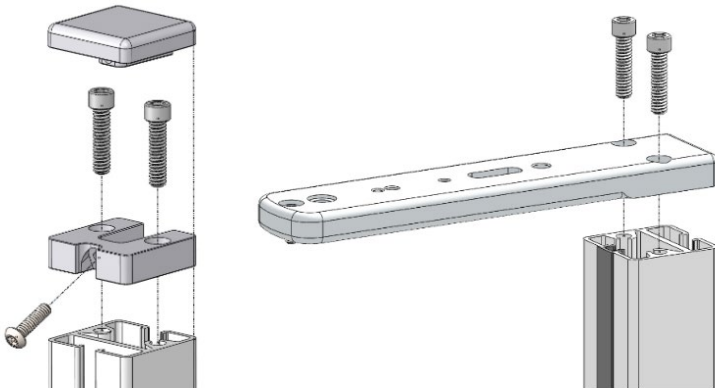



## 20. LOGITECH MEETUP & RALLY, FIXED BRACKET – BRACKET & CAMERA INSTALLATION

- Remove Channel Cover Strip (ref. point 4).
- Install Logitech bracket to extrusion with one (1) screw and (1) Z-nut.
- Remove screws and cap with Allen L-key provided.
- Install camera by placing camera slot over bracket ledge.
- Re-install screws and cap with Allen L-key provided.

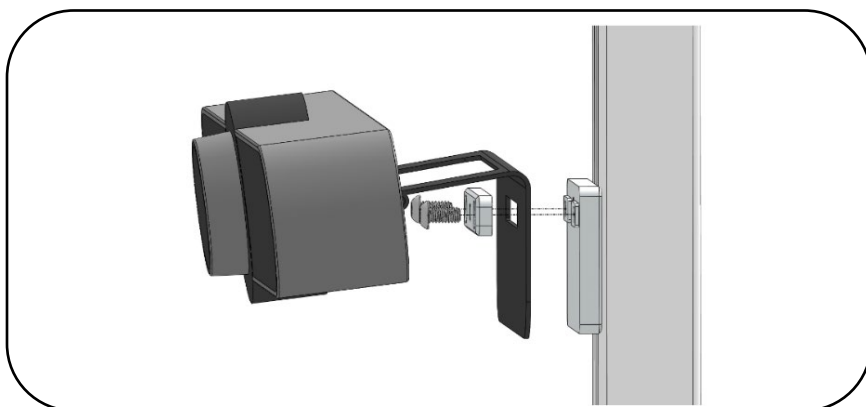
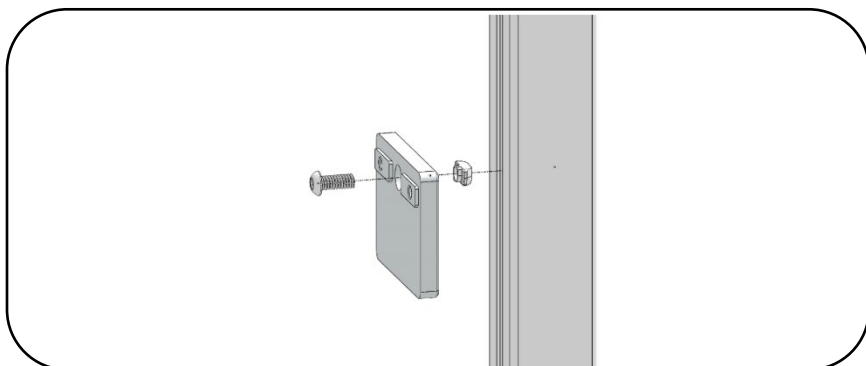

## 21. LOGITECH MEETUP & RALLY, 180 PAN BRACKET – BRACKET & CAMERA INSTALLATION

- Remove channel cover from front extrusion (ref. step 5).
- Install Logitech bracket to extrusion with two (2) screws and two (2) Z-Nuts.
- Remove screws and cap with Allen L-key provided.
- Install camera by placing camera slot over bracket ledge.
- Re-install screws and cap with Allen L-key provided.

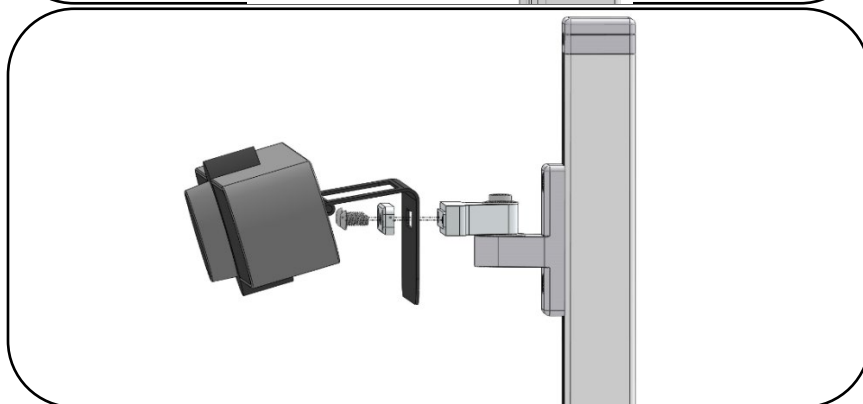
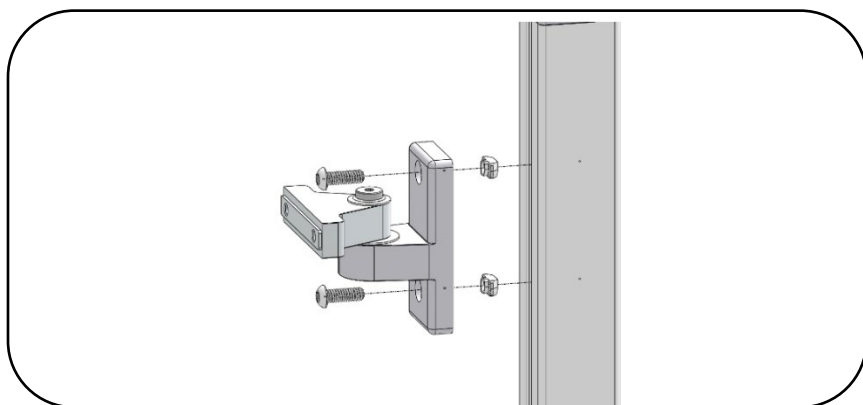

## 22. JABRA 410/510 – BRACKET & SPEAKER INSTALLATION

- Remove Channel Cover Strip (ref. point 4).
- Remove screw and cap using Torx Security L-Key provided.
- Install Jabra 410 and 510 Bracket to extrusion with screw and Z-Nut.
- Install speaker by sliding speaker ledge into bracket lip with wire either at top or bottom.
- Re-install cap and screw using Torx Security L-Key provided.

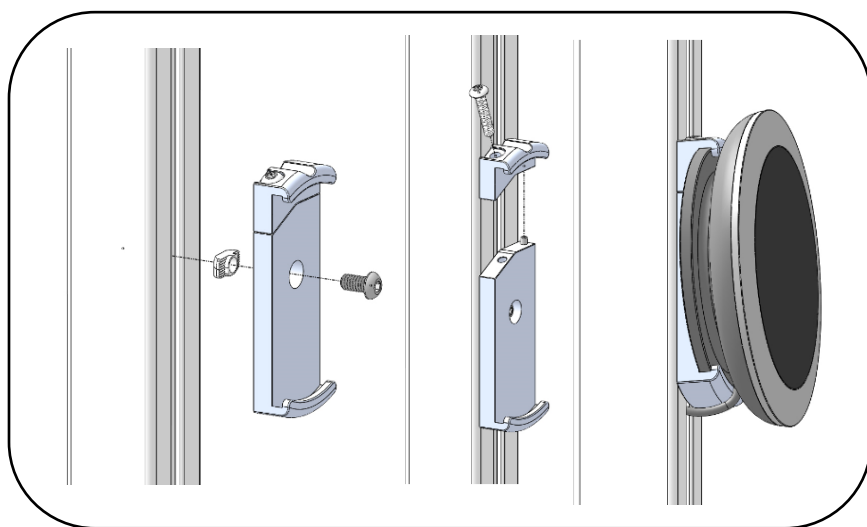

## 23. JBL CHARGE 4 AND FLIP 5 – BRACKET & SPEAKER INSTALLATION

- Remove Channel Cover Strip (ref. point 4).
- Install JBL Charge 4 bracket to extrusion with two (2) screws and (2) Z-nuts.
- Remove screws and cap using Torx Security L-Key provided.
- Install speaker by sliding speaker ledge into bracket lip.
- Re-install cap and screw using Torx Security L-Key provided.

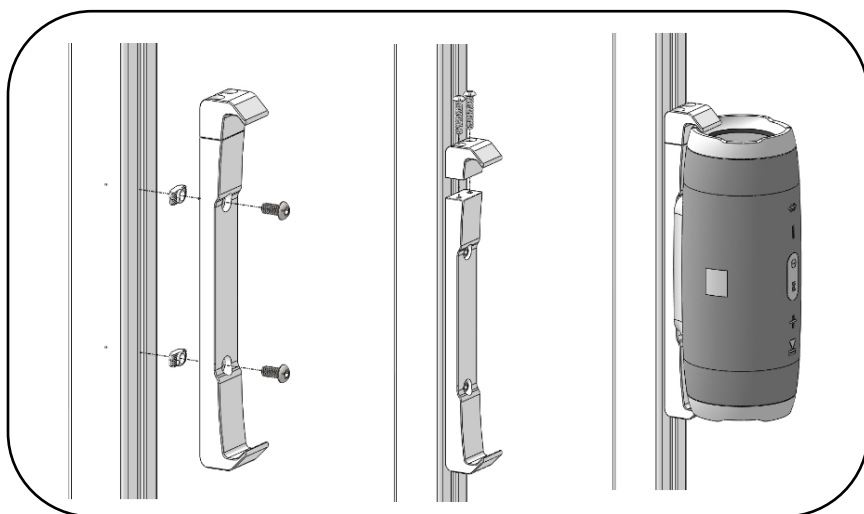

## 24. JBL GO2 – BRACKET & SPEAKER INSTALLATION

- Remove Channel Cover Strip (ref. point 4).
- Install JBL GO2 bracket to extrusion with screw and Z-nut.
- Remove screw and block using Torx Security L-Key provided.

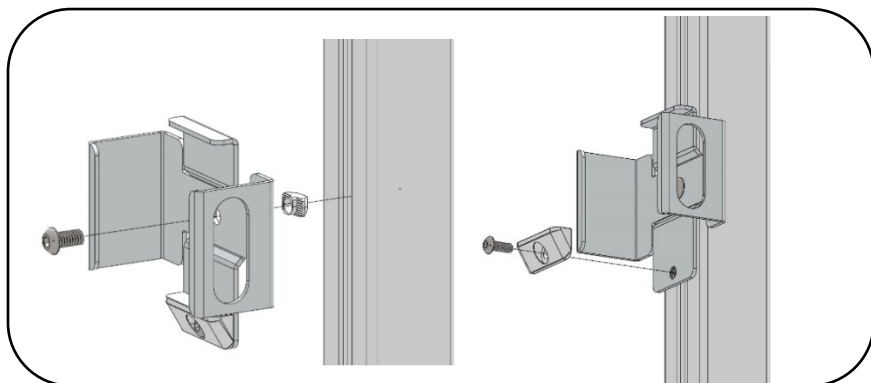

- Install speaker by sliding speaker into bracket tabs from underneath.
- Re-install screw and block with Allen key provided.

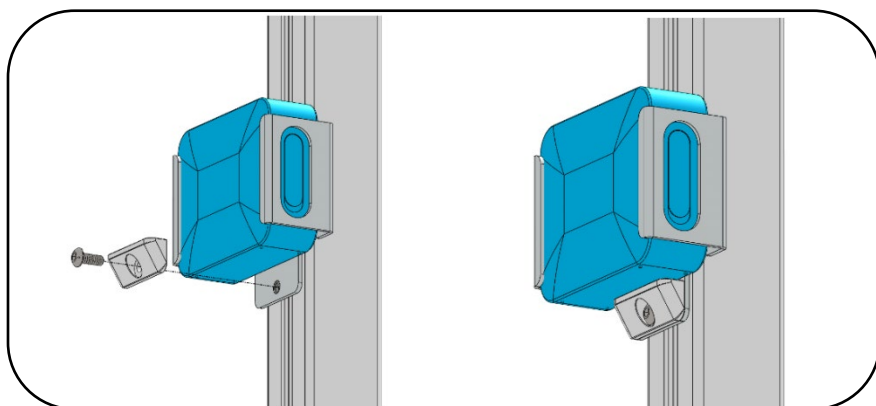

## 25. INTEL NUC – BRACKET & UNIT INSTALLATION

- Remove Channel Cover Strip (ref. point 4).
- Install Intel NUC bracket to extrusion with screw and Z-nut.
- Install Intel NUC by lining up holes of bracket and unit.
- Install 2 screws with Allen L-key provided.

