

T2522 JBL Speaker Bracket Nova Go & 2 Assembly Instructions

Hardware Pack Contents:

- (2) 1/4-20 x 1/2" long socket head cap screw
- (1) 3/16 hex key
- (1) 10-32 x 1" button head security screw
- (1) 10-32 x 5/8" button head security screw
- (1) 5-32 security hex key
- (2) 1/4-20 T-nut

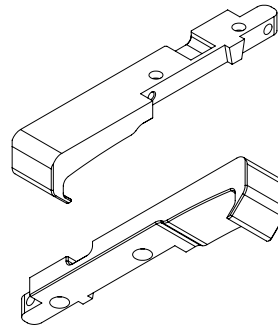

Left Bracket
(Top & Bottom View)

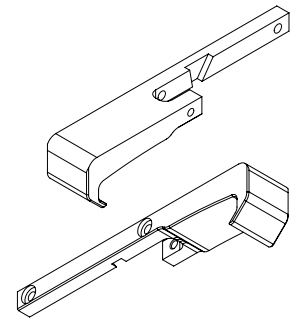

Right Bracket
(Top & Bottom View)

Floating Power Box Hardware Pack Contents:

- (2) 1/4-20 Z-nut
- (2) 1/4-20 x 1/2" button head socket cap screw

Instructions:

1. Remove channel cover from main pole of Nova 2 or Nova Go.
2. Open the power box by removing the 2 screws at the back of the power box using allen key.
NOTE: be careful to hold on to the power box cover so it does not drop while you remove the screws. Slide the power box cover off.
3. Plug the iPad power charger into the grey extension cord. Plug the JBL charging cable into the Apple charger and feed it out the top of the power box. Install the cover back onto the power box.
4. Run the JBL charging cable up the channel and while holding onto the JBL cable and lightning cable going up to the top of the pole, and with 2 cables coming out of the side slot in the left bracket, mount the left bracket with hook end facing down into Nova pole using the 2 1/4-20 x 1/2" long socket head cap screws and 2 T-nuts and tighten with supplied 3/16 allen key.
5. Place JBL speaker onto left bracket hook and slide right bracket hook over top of the other end of the speaker and slide right bracket into left bracket against Nova pole until 2 side screw holes align.
6. Insert the 10-32 x 1" button head security screw into the top screw hole of the right bracket and tighten using 5-32 security hex key.
7. Insert the 10-32 x 5/8" button head security screw into the bottom screw hole of the right bracket and tighten using 5-32 security hex key.
8. Plug the cables into the JBL speaker slots for charging.
9. Reinstall channel cover. Note you will need to use sharp scissors to cut it shorter to allow for the JBL bracket.

Installing Floating Power Box:

1. If you have purchased a Work Surface Tray and JBL Bracket you will need to install the power box lower down on the main pole.
2. Remove the power box cover first.
3. Remove the power box base and re-install using the supplied Z nuts and screws.